

# INSTRUCTION MANUAL



**IGT8**  
www.igt8.com

HIGH PERFORMANCE RC

**B8** 2021  
Nitro Buggy

For any additional questions, please send us an email to: [info@igt8.com](mailto:info@igt8.com)

# OVERVIEW

## Components



IGT8 Stickers



USB Manual



Parts Bag

## TOOLS NOT INCLUDED IN THE KIT



Body Reamer



Screw Cement



Instant Cement



Curved Scissors



Cutter



Gear Grease



Needle Nosed Pliers



Craft Knife



Precision Caliper

## Equipment Needed



Glow Fuel



Fuel Bottle



Glow Plug



Receiver Battery Charger



Glow Igniter



Receiver Battery



Starter Box

# 1 ASSEMBLY OF THE FRONT AND REAR DIFF.

**BAG 1**

Build two differentials for front and rear.

**Step 1**

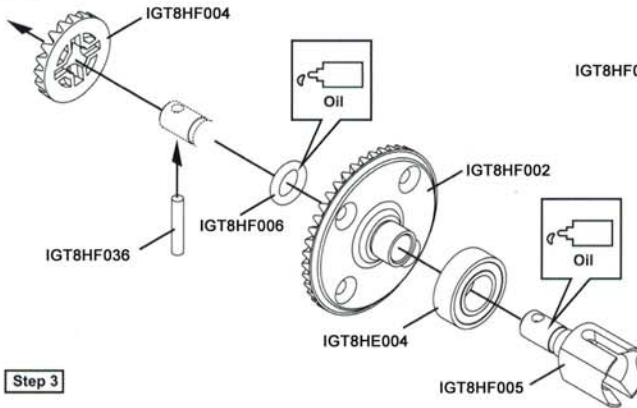

**Step 2**

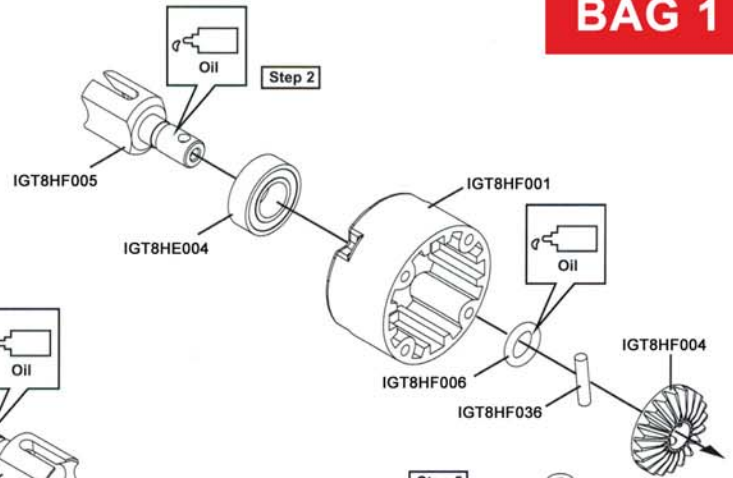

**Step 3**

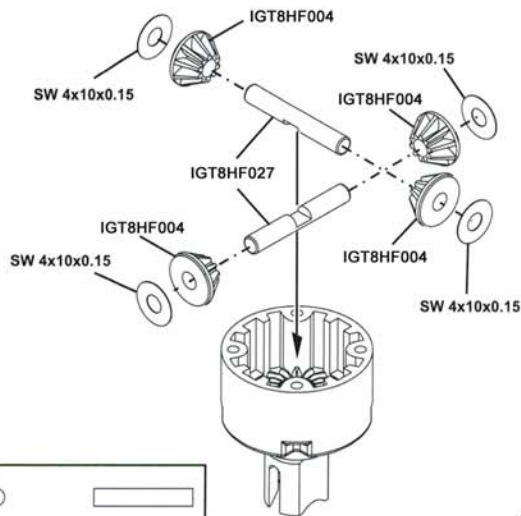

**Step 4**



**Step 5**

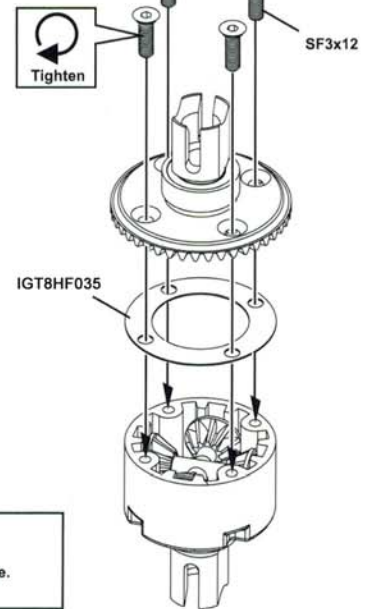

- Use diff oil 7,000 for front and 3,000 for rear.
- Use White Oil pen mark front diff. case and rear diff. case.

	IGT8HF036 2.5x11.8mm Pin	.....x4
	IGT8HF006 P6 O-Ring	.....x4
	IGT8HE004 8x16x5mm Ball Bearing	.....x4
	SW 4x10x0.15 4x10x0.15mm Washer	.....x8
	IGT8HF027 4mm Cross Pin	.....x4
	SF3x12mm Flat Head Hex Screw	.....x8

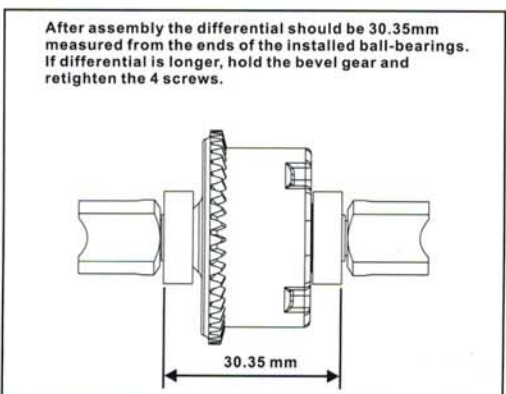
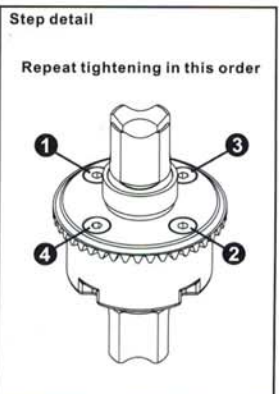
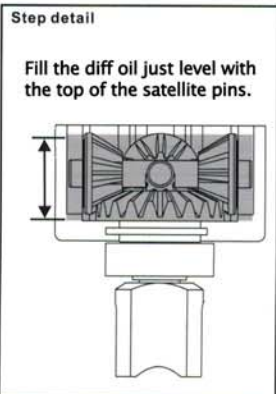
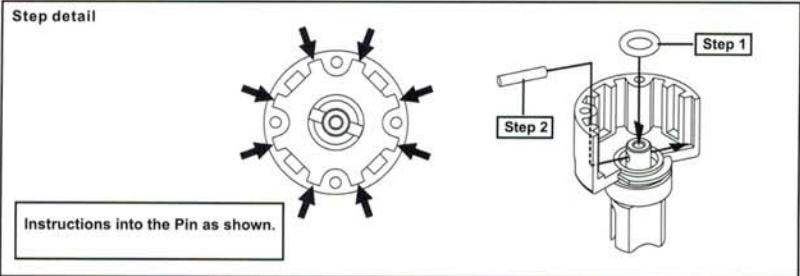
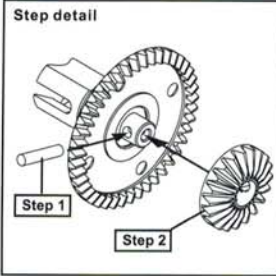
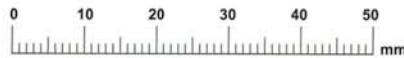

## 2 ASSEMBLY OF THE CENTER DIFF.

**BAG 1**

Step 1

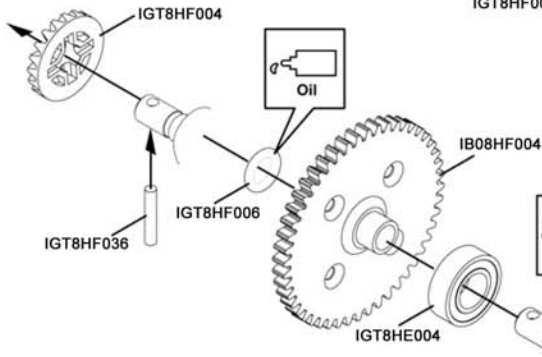

Step 2

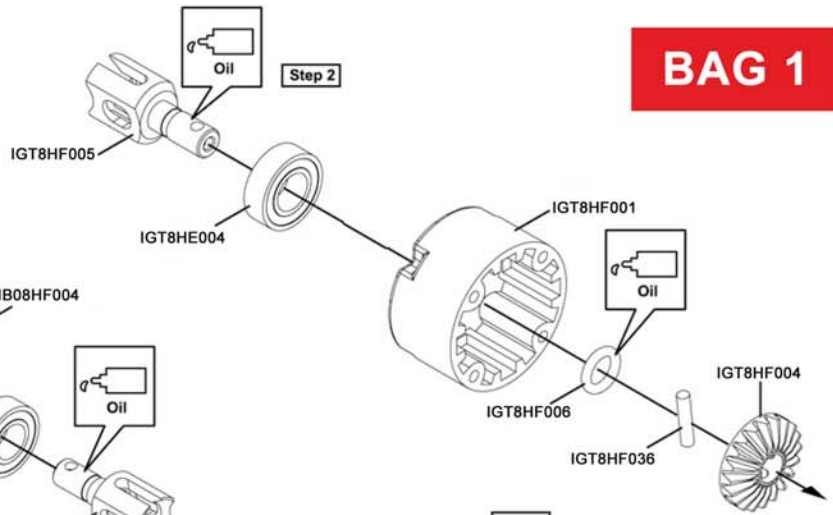

Step 3

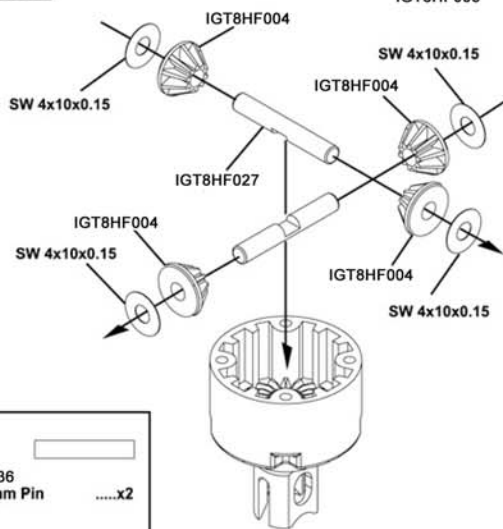

Step 4



Use the Diff. Oil #5000 for the center diff.

Step 5

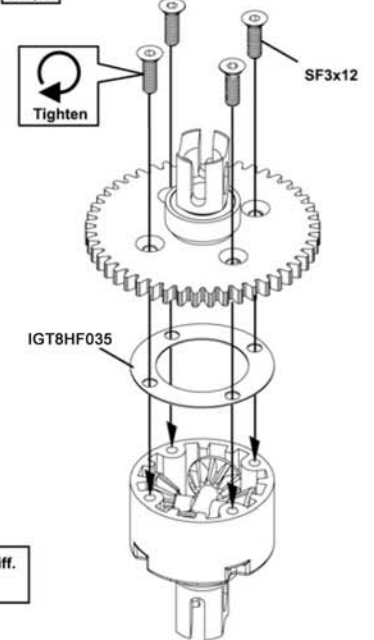

IGT8HF036  
2.5x11.8mm Pin .....x2

IGT8HF006  
P6 O-Ring .....x2

IGT8HE004  
8x16x5mm  
Ball Bearing .....x2

SW 4x10x0.15  
4x10x0.15mm  
Washer .....x4

IGT8HF027  
4mm Alum. Cross Pin .....x2

SF3x12mm  
Flat Head Hex Screw .....x4



Step detail

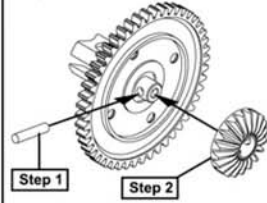

Step detail

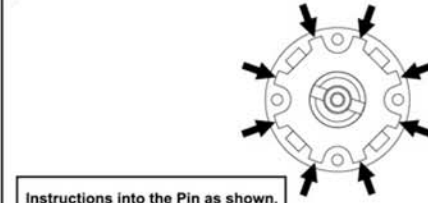

Instructions into the Pin as shown.

Step detail

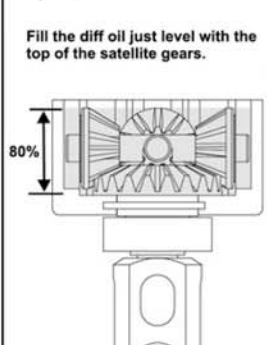

Fill the diff oil just level with the top of the satellite gears.

Step detail

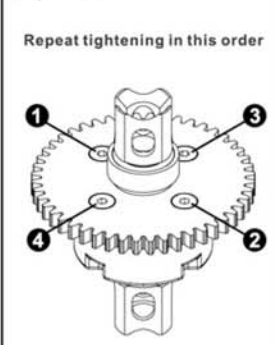

Repeat tightening in this order

After assembly the differential should be 31.2mm measured from the ends of the installed ball-bearings. If differential is longer, hold the bevel gear and retighten the 4 screws.

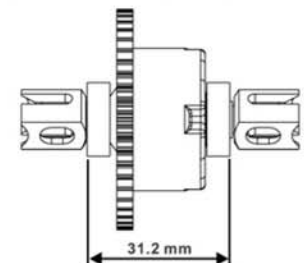



**4 ASSEMBLY OF THE FRONT GEAR CASE**

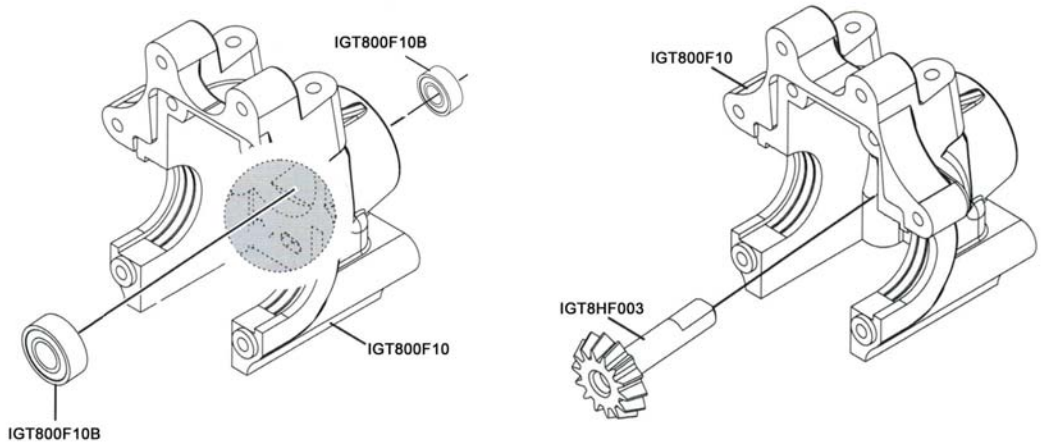
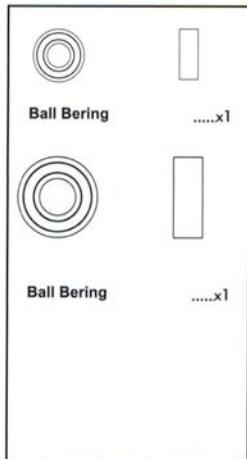

**BAG 2**

**5 ASSEMBLY OF THE FRONT DIFFERENTIAL INTO GEAR CASE**

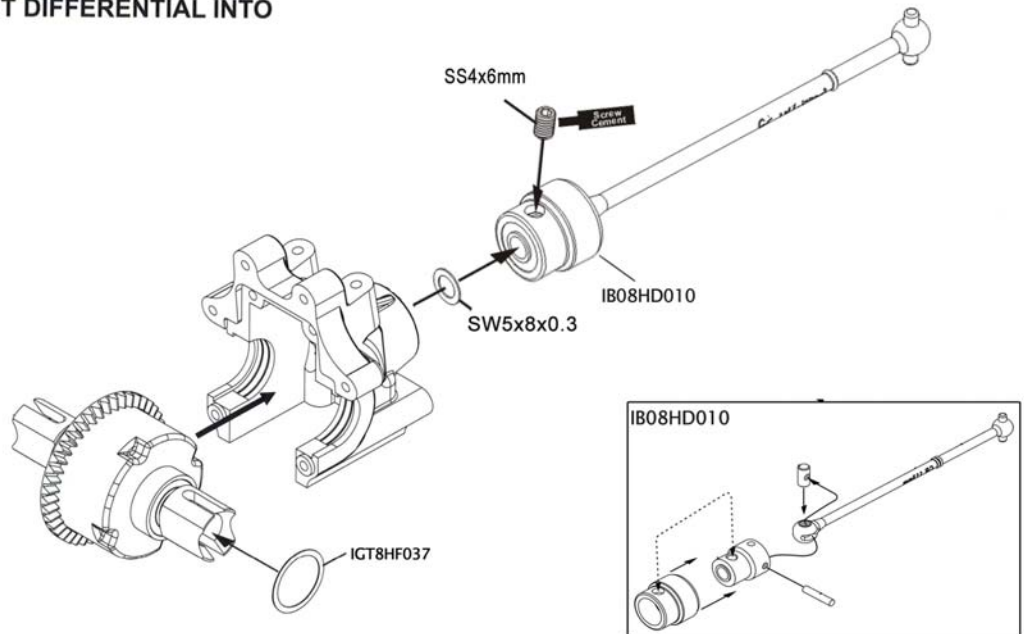

## 6 ASSEMBLY OF THE FRONT DIFFERENTIAL INTO GEAR CASE

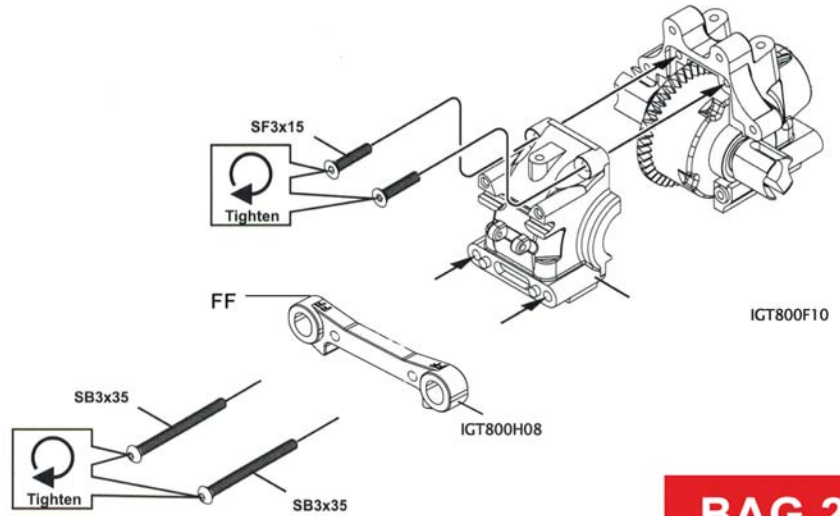
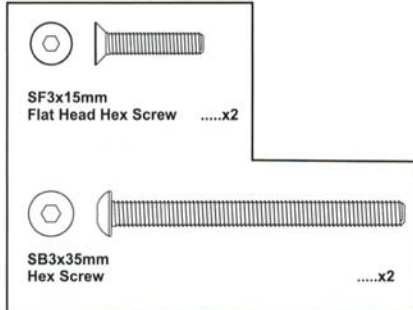

**BAG 2**

## 7 ASSEMBLY OF THE FRONT SHOCK STAY

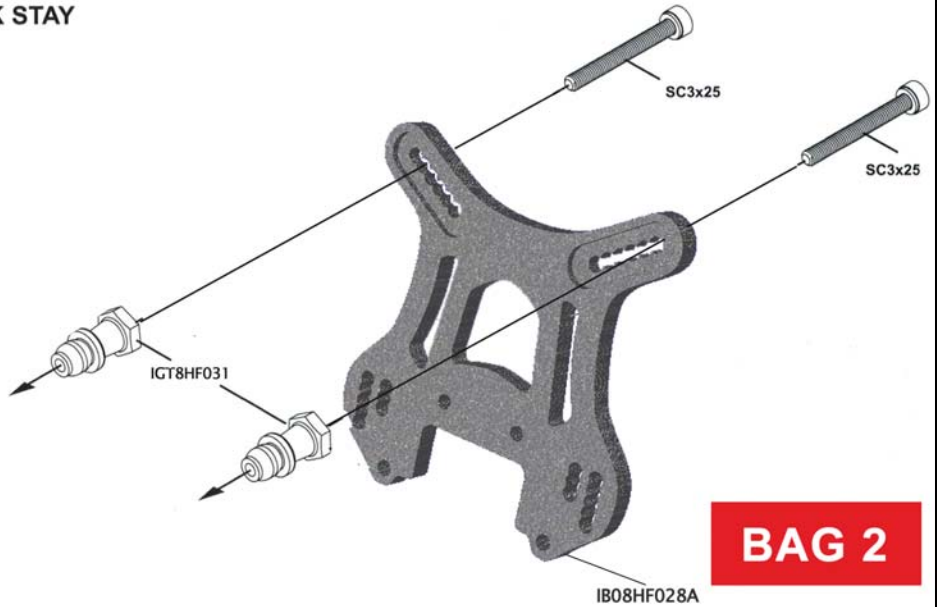
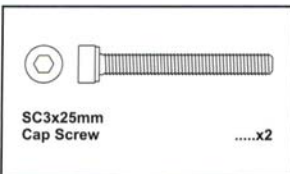

**BAG 2**

## 8 ASSEMBLY OF THE FRONT SHOCK STAY ONTO GEAR CASE

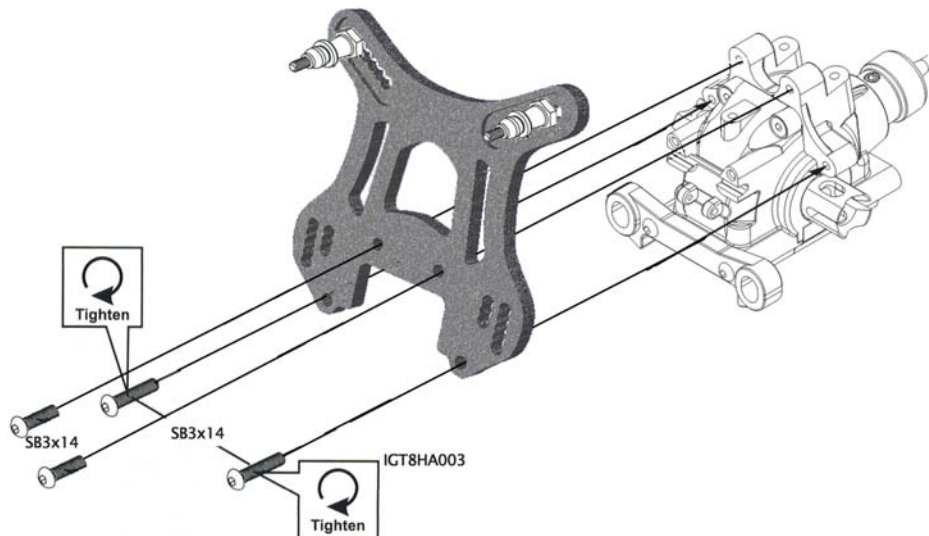
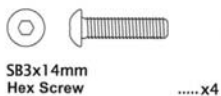

# 9 ASSEMBLY OF THE FRONT LOWER ARMS

Assemble both right and left sides.

Step detail

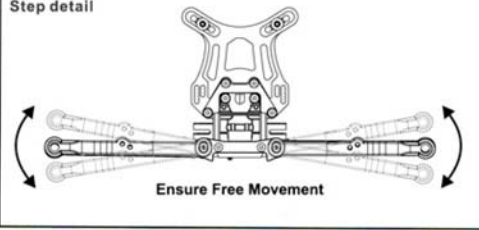

IGT8HF046  
4x10mm  
Round Head Set Screw .....x2

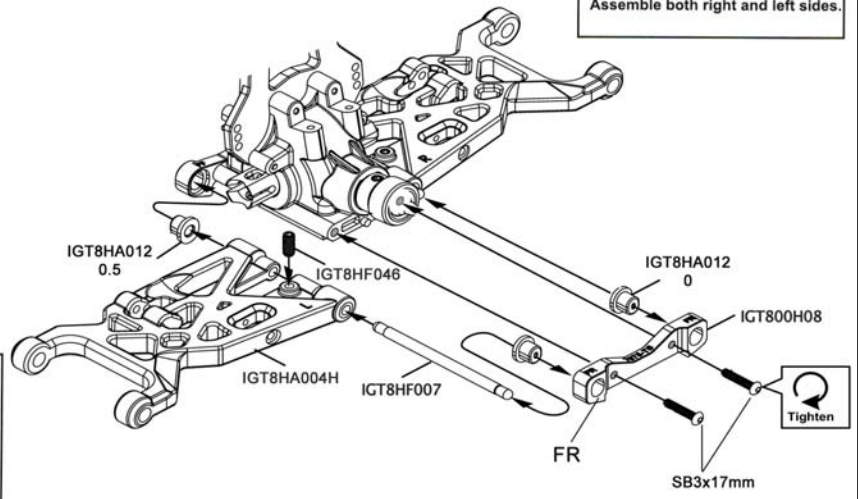

**BAG 2**



# 11 ASSEMBLY OF THE FRONT STABILIZER ROD

**BAG 2**

Step detail

Ensure Free Movement

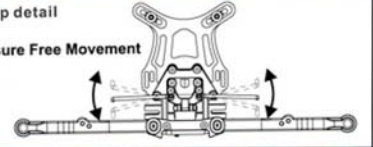

SB2.5x8mm  
Hex Screw .....x2

SC2x12mm  
Cap Screw .....x1

SB3x20mm  
Hex Screw .....x2

SS3x3mm  
Set Screw .....x4

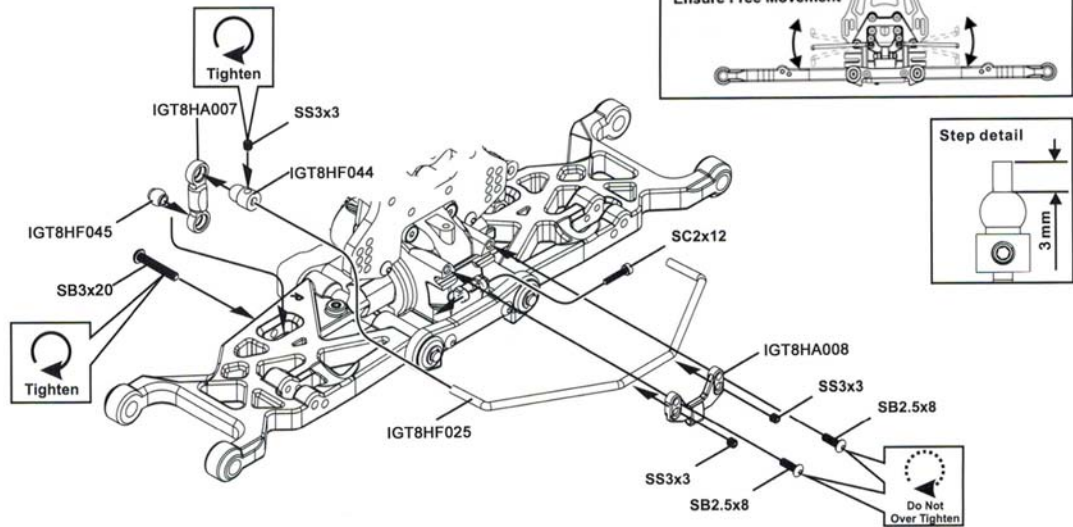

Step detail

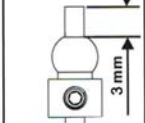

Do Not Over Tighten

# 12 ASSEMBLY OF THE FRONT KNUCKLE ARMS

**BAG 2**

**LEFT SIDE**

**Step 1**

IGT8HE001 13x20x4mm Ball Bearing .....x2

IGT8HE006 8x14x4mm Ball Bearing .....x2

SS3x6mm Set Screw .....x4

3xmm Nylon Nut .....x2

**Step 2**

IGT800F344 IGT8HE001

IGT800F38 Note.- Kit comes with caster block insert #4 (10° and 18°)

IGT8HA013 SNN3 IGT8HE006 IGT8HF040

**Optional Caster Block Inserts #**  
 IGT800F340 - Caster Block Insert #0 (14°)  
 IGT800F341 - Caster Block Insert #1 (13°/15°)  
 IGT800F342 - Caster Block Insert #2 (12°/16°)  
 IGT800F346 - Caster Block Insert #6 (8°/20°)  
 IGT800F348 - Caster Block Insert #8 (6°/22°)

**Step 3**

IGT8HF040

**Step detail**

IGT8HF040 3x6

Sst Screw position

SS3x6

SS3x6

**Assemble both right and left sides.**

# 13 ASSEMBLY OF THE FRONT CVD INTO KNUCKLE ARMS

**BAG 2**

**LEFT SIDE**

**Assemble both right and left side.**

IGT8HF070 2.5x12.8mm Pin .....x2

IGT8HF039 2.5x16.8mm Pin .....x2

SS4x4mm Set Screw .....x2

CVD 105mm

IGT800H05A IGT8HF070 IGT8HD004 IGT8HF071

IGT8HF039 IGT8HF052

Use screw cement (blue)

SS4x4

**Tighten**

# 14 ASSEMBLY OF THE KNUCKLE ARMS ONTO FRONT LOWER ARMS

**Assemble both right and left sides.**

**Step detail**

**Ensure Free Movement**

\*Insert the front drive shaft into cap joint before assembly.

Use screw cement (blue)

SB4x14

Do Not Over Tighten

SB4x14 IGT8HF042

Use screw cement (blue)

SB4x14 Hex Screw .....x4





# 15 ASSEMBLY OF THE FRONT UPPER ARMS

**BAG 2**

Assemble both left and right sides.

LEFT SIDE

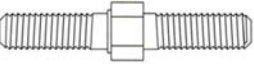
-  IGT8HF033 7x12mm Ball .....x2
-  IGT8HF038 7mm Ball .....x2
-  IGT8HF023 5x35mm Turnbuckle .....x2

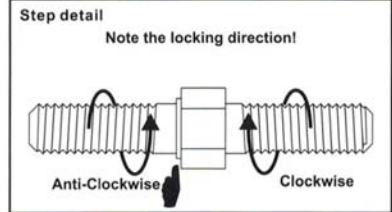
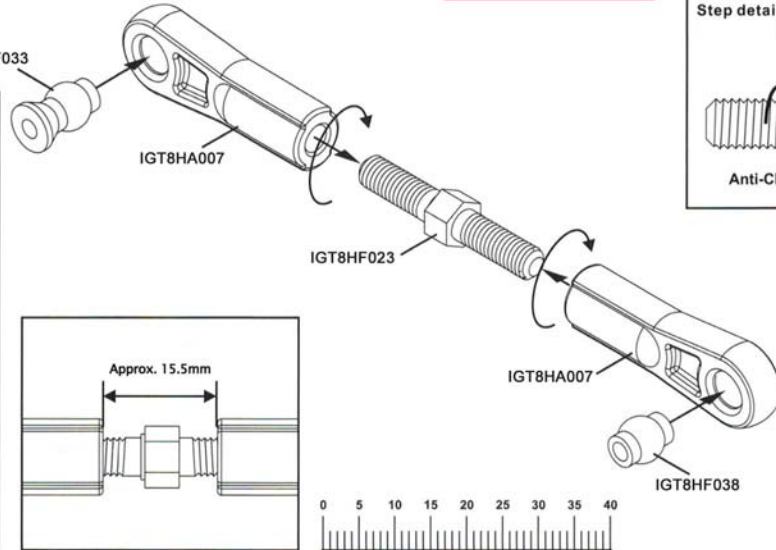

# 16 ASSEMBLY OF THE FRONT UPPER ARMS

Assemble both right and left sides.

LEFT SIDE

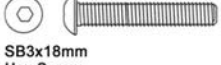
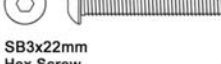

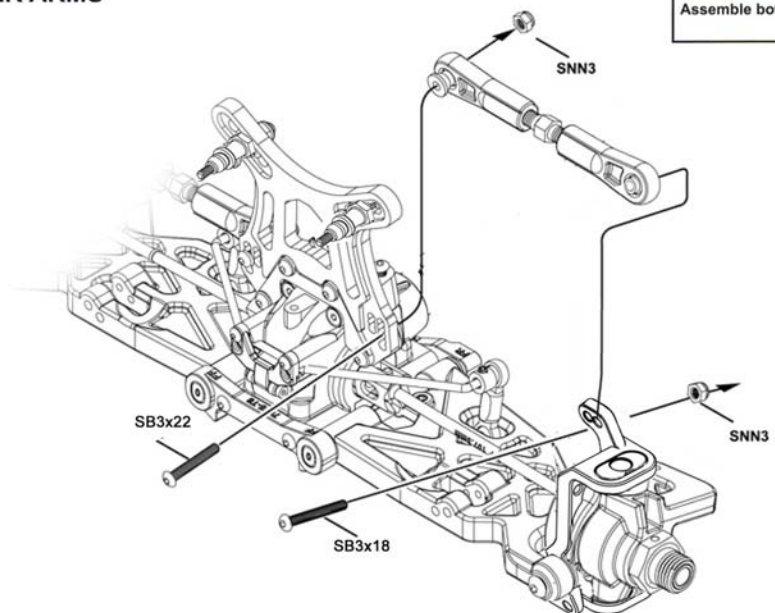
-  SNN3mm Nylon Nut .....x4
-  SB3x18mm Hex Screw .....x2
-  SB3x22mm Hex Screw .....x2



# 17 ASSEMBLY OF THE SERVO SAVER

**BAG 3**

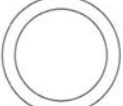
Servo saver spring preload.

-  IGT8HF029 Steering Plat Hex Screw .....x2
-  IGT800H10 12x1.7mm O-Ring .....x1
-  SNN3mm Nylon Nut .....x3
-  SW4x8x0.25 Washer .....x2

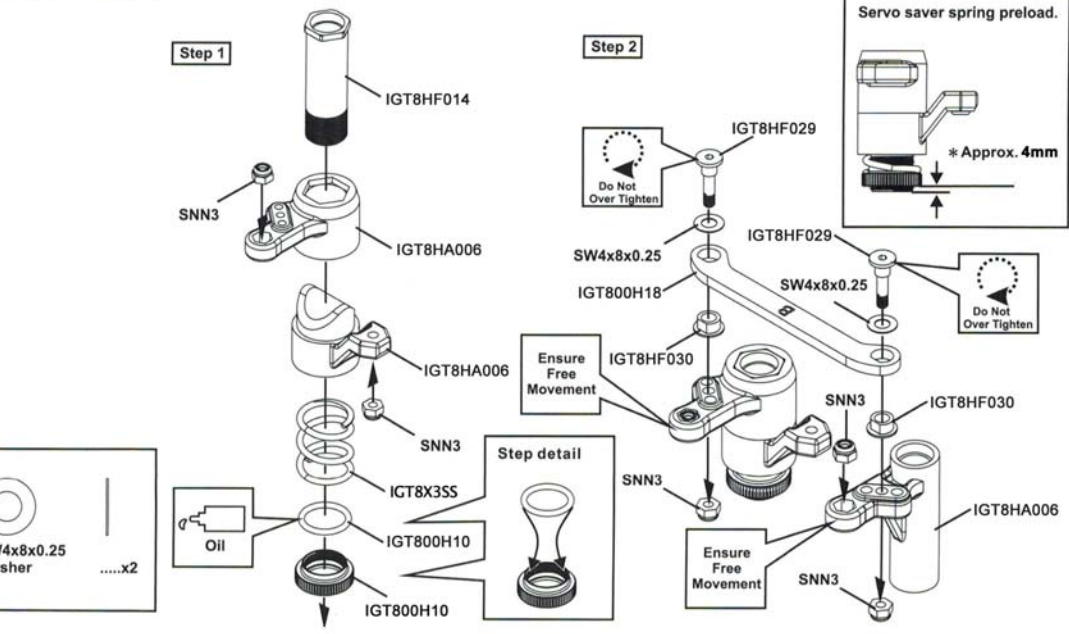

# 18 ASSEMBLY OF THE FRONT PLATE ONTO SERVO SAVER

**SNN3mm Nylon Nut** .....x1

**SB3x10mm Hex Screw** .....x3

**SW3x6x0.5 Washer** .....x2

**BAG 3**

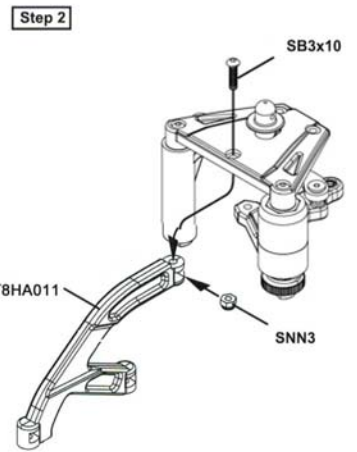
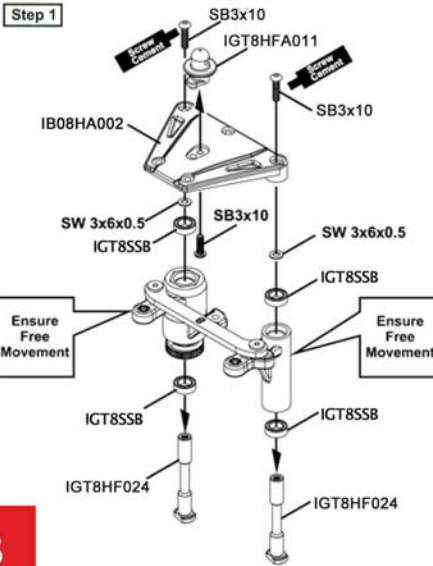

# 19 ASSEMBLY OF THE STEERING TIE-ROD

Make two steering rods for left and right hand sides.

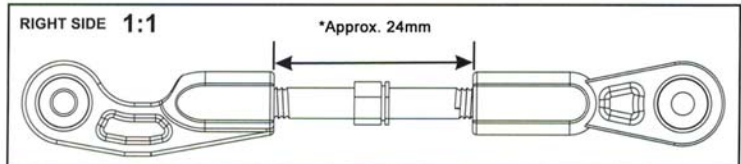
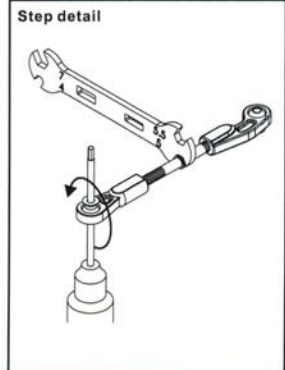
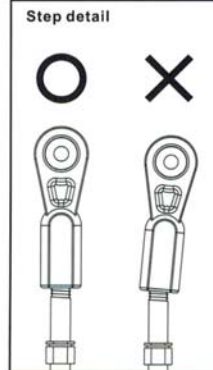
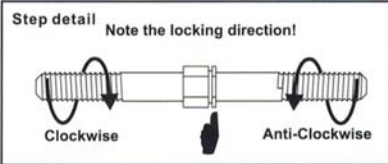
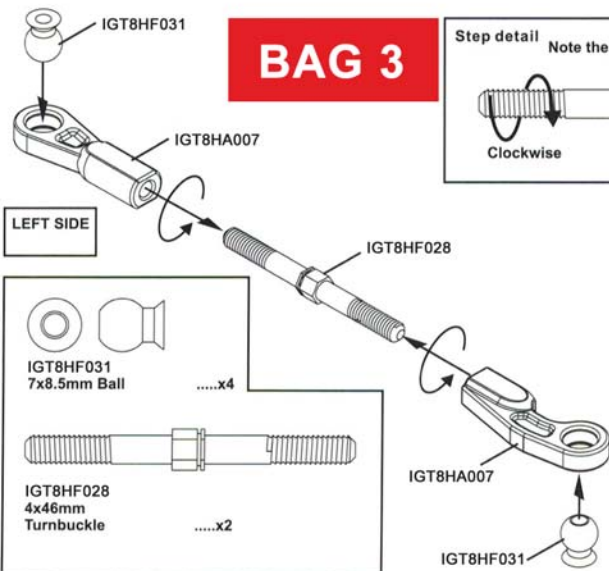

# 20 ASSEMBLY OF THE STEERING TIE-ROD

**BAG 3**

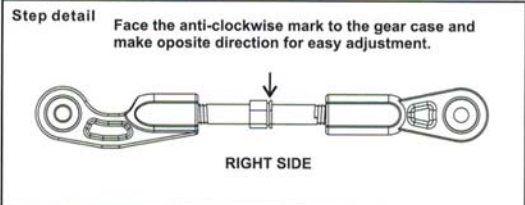

**SF3x16mm Flat Head Hex Screw** .....x2

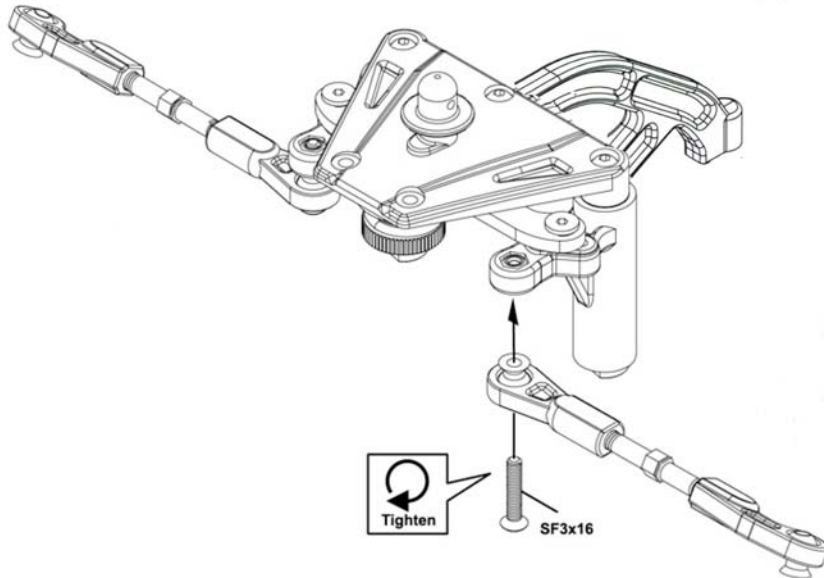

**21 ASSEMBLY OF THE SERVO SAVE R ONTO THE FRONT GEAR BOX**

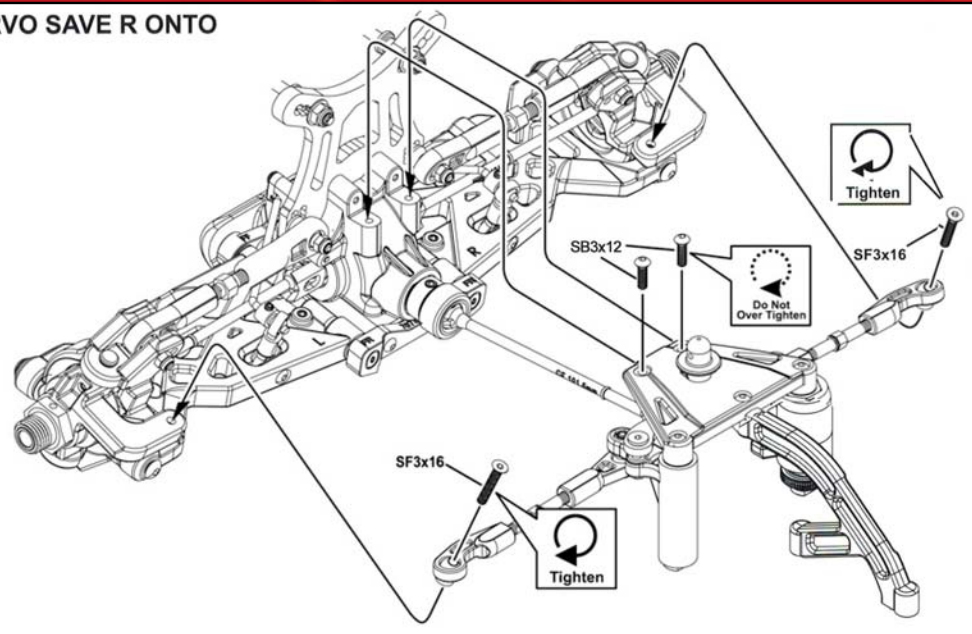

- |  |                                 |         |
|--|---------------------------------|---------|
|  | SF3x16mm<br>Flat Head Hex Screw | .....x2 |
|  | SB3x12mm<br>Hex Screw           | .....x2 |

**22 ASSEMBLY OF THE REAR GEAR CASE**

**BAG 4**

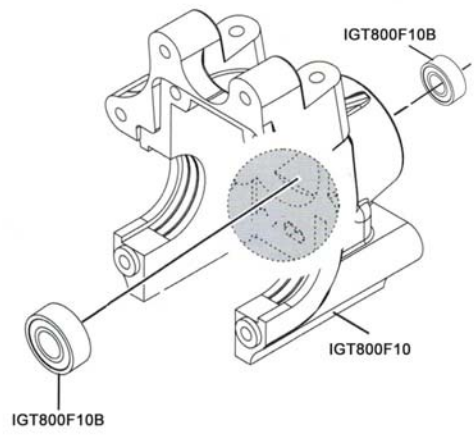

- |  |             |         |
|--|-------------|---------|
|  | Ball Bering | .....x1 |
|  | Ball Bering | .....x1 |

**23 ASSEMBLY OF THE REAR GEAR CASE**

**BAG 4**

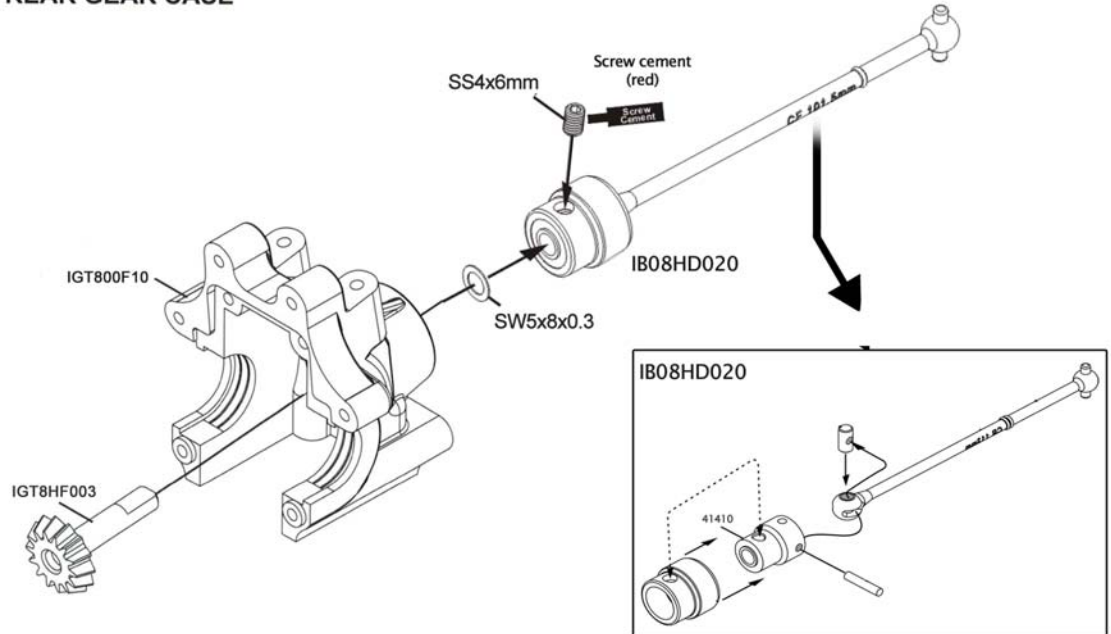

- |  |                       |         |
|--|-----------------------|---------|
|  | SW5x8x0.3mm<br>Washer | .....x1 |
|--|-----------------------|---------|

## 24 ASSEMBLY OF THE REAR DIFFERENTIAL INTO GEAR CASE

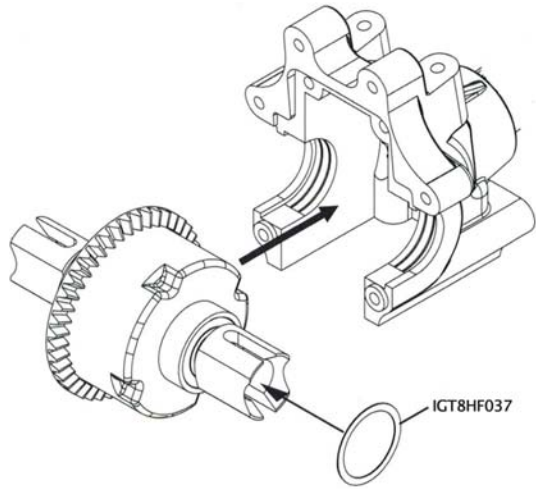
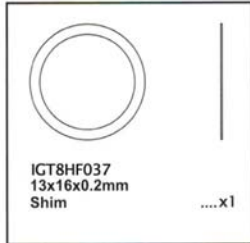

**BAG 1**

**BAG 4**

## 25 ASSEMBLY OF THE REAR GEAR CASE COVER AND LOWER ARM HOLDERS

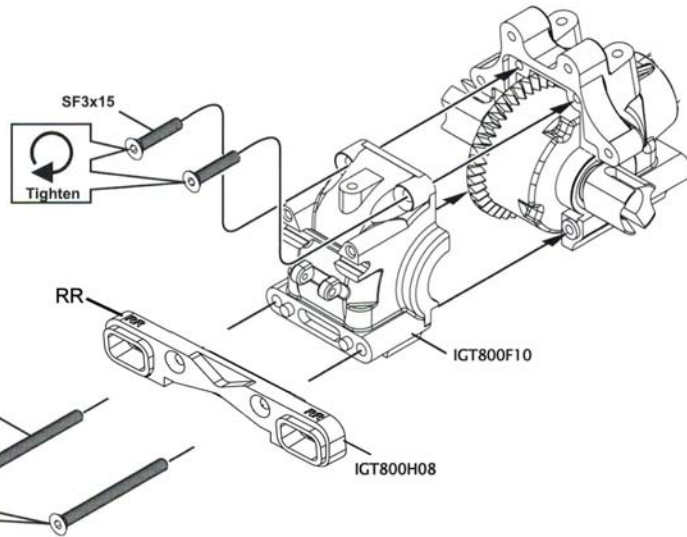
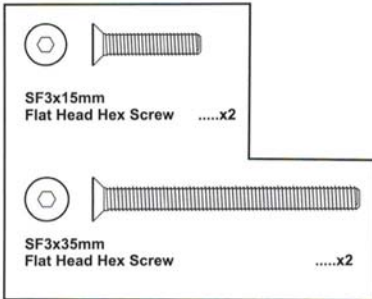

**BAG 4**

**BAG 11**

## 26 ASSEMBLY OF THE REAR BRACE MOUNT

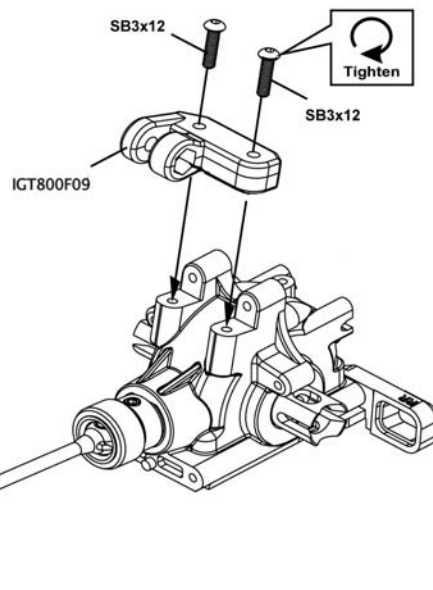

**BAG 4**

## 27 ASSEMBLY OF THE REAR SHOCK STAY

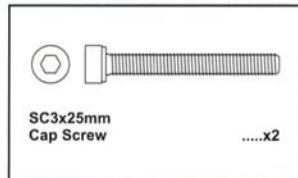
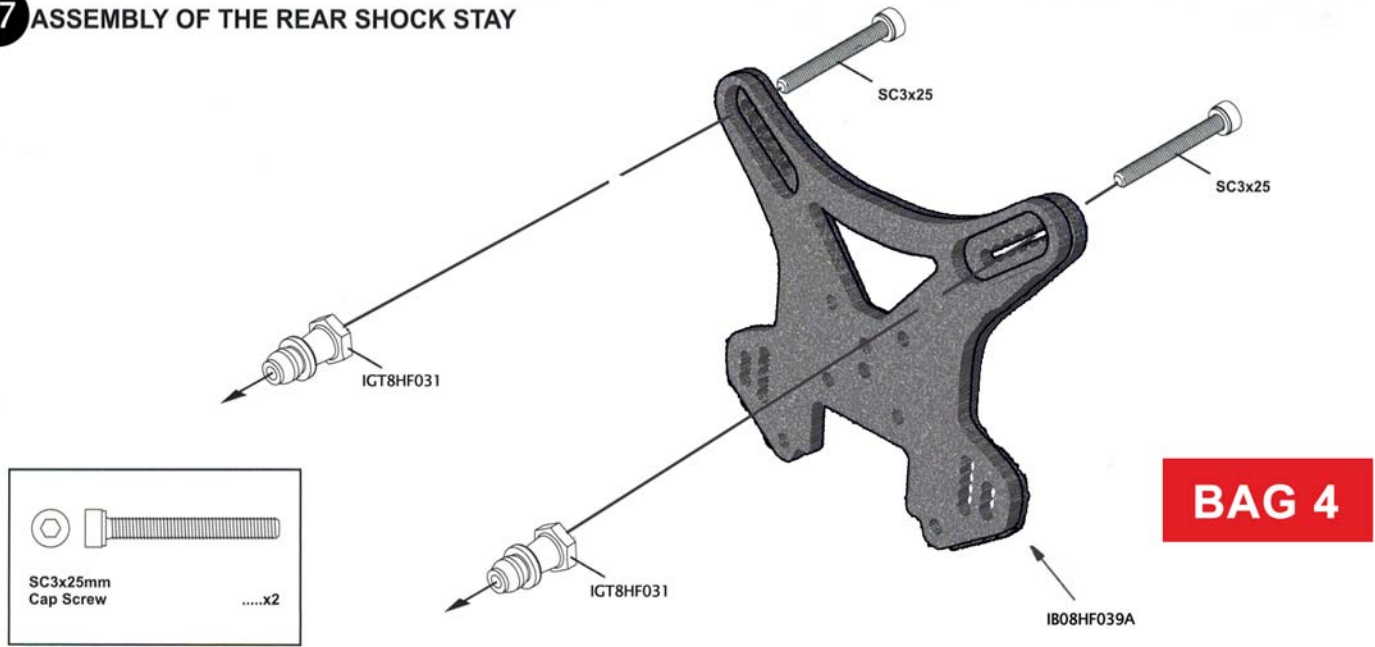

## 28 ASSEMBLY OF THE REAR SHOCK STAY ONTO REAR GEAR CASE

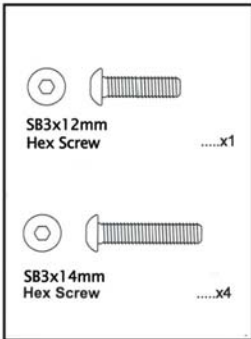
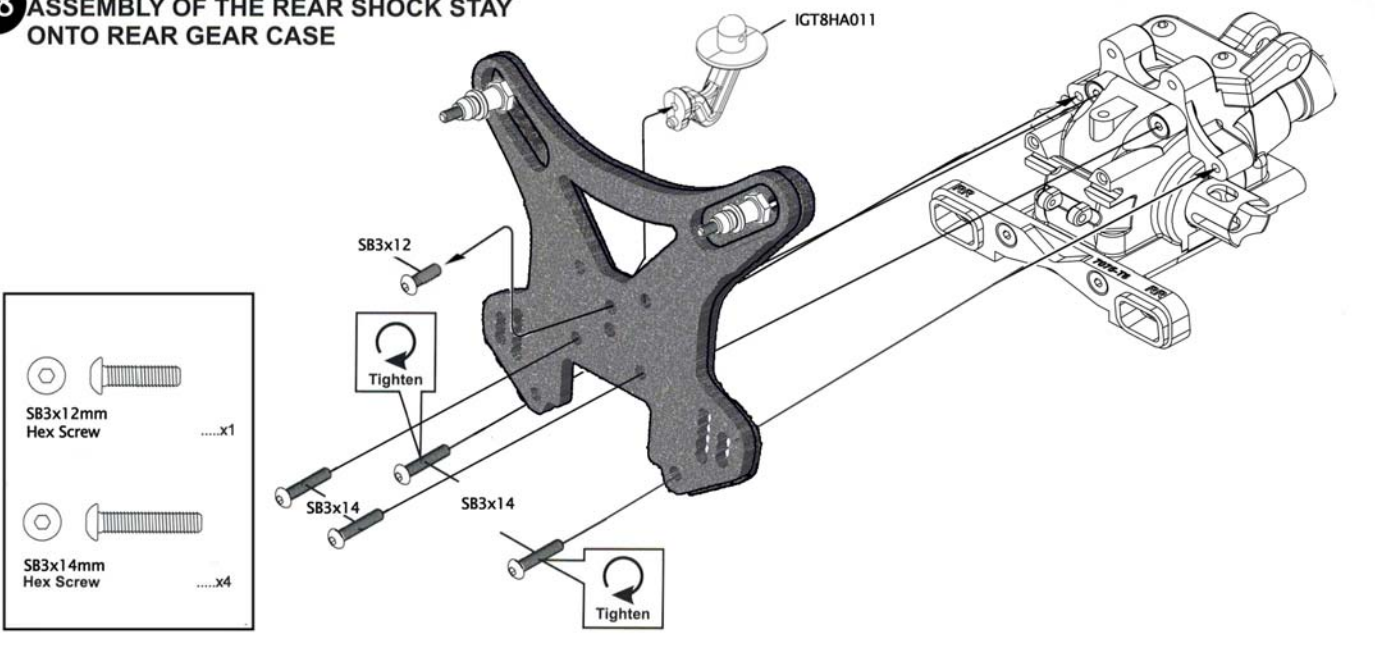

## 29 ASSEMBLY OF THE REAR LOWER ARMS

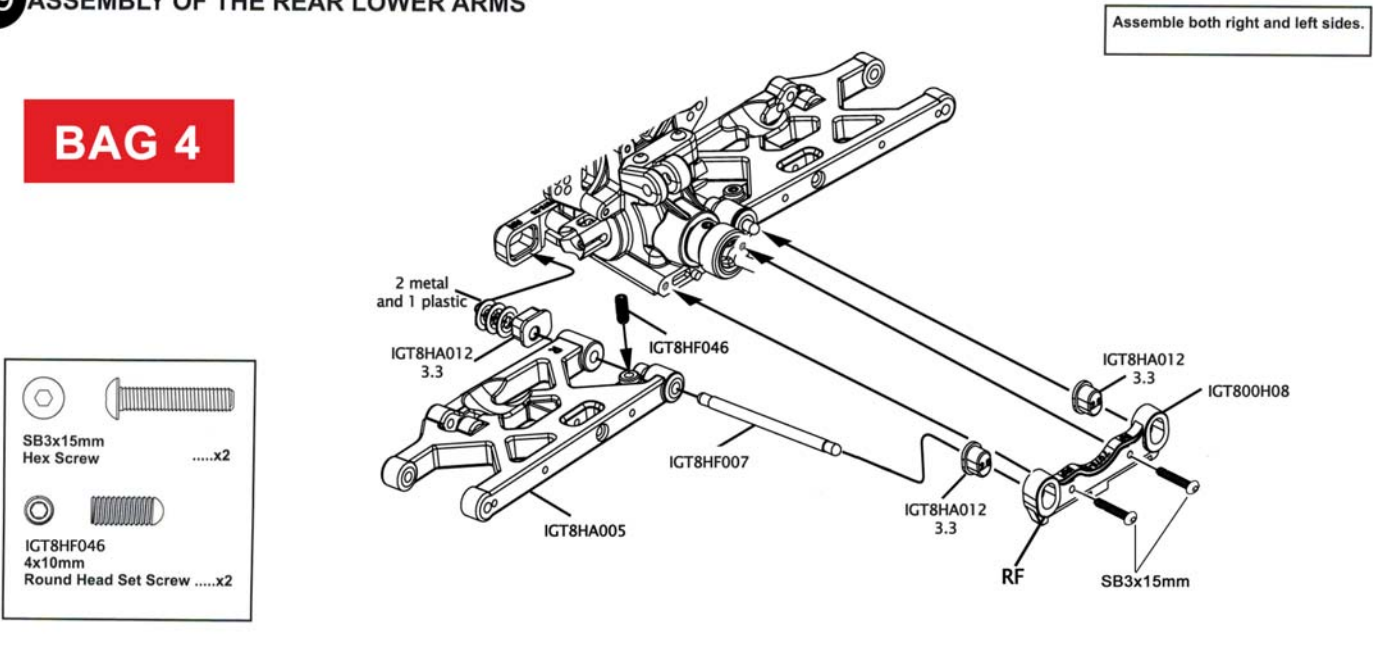

### 30 ASSEMBLY OF THE REAR STABILIZER

**BAG 4**

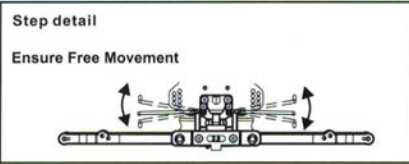
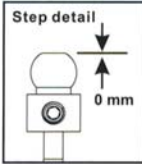

- SB2.5x8mm Hex Screw .....x2
- SC2x12mm Cap Screw .....x1
- SB3x18mm Hex Screw .....x2
- SS3x3mm Set Screw .....x4

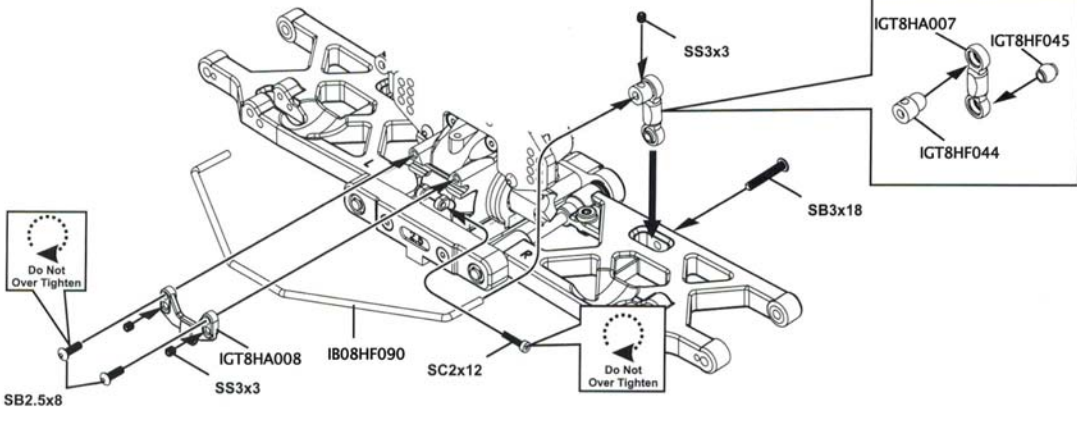

### 31 ASSEMBLY OF THE REAR WHEEL HUBS

**BAG 4**

- IGT8HF039 2.5x16.8mm Pin .....x2
- 4x4mm Set Screw .....x2

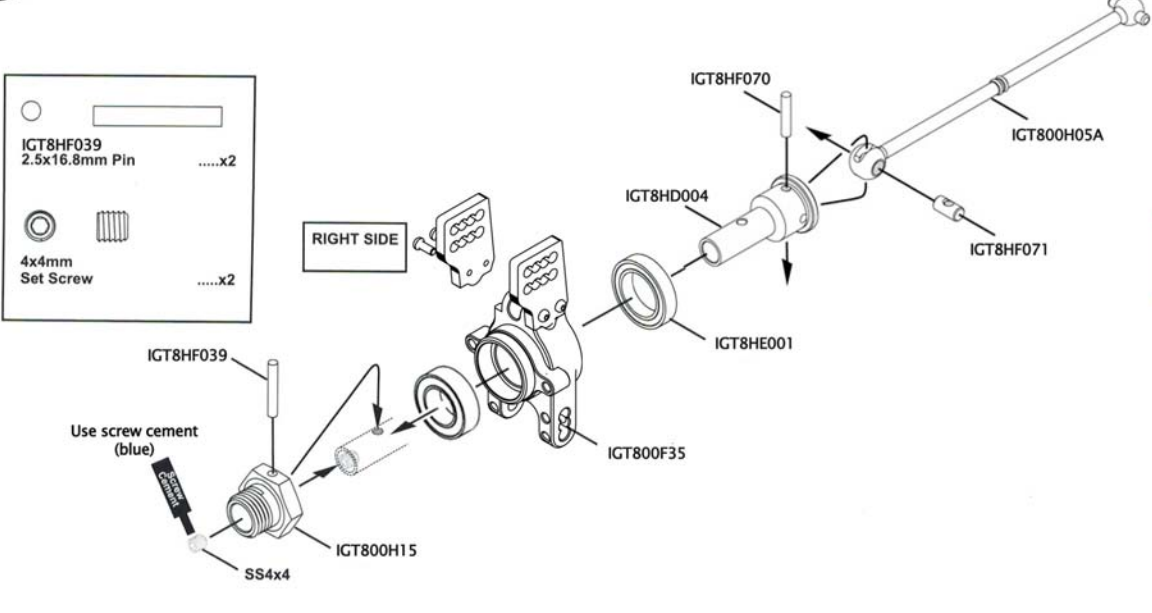

### 32 ASSEMBLY OF THE REAR SUSPENSION ARMS

Assemble both right and left sides.

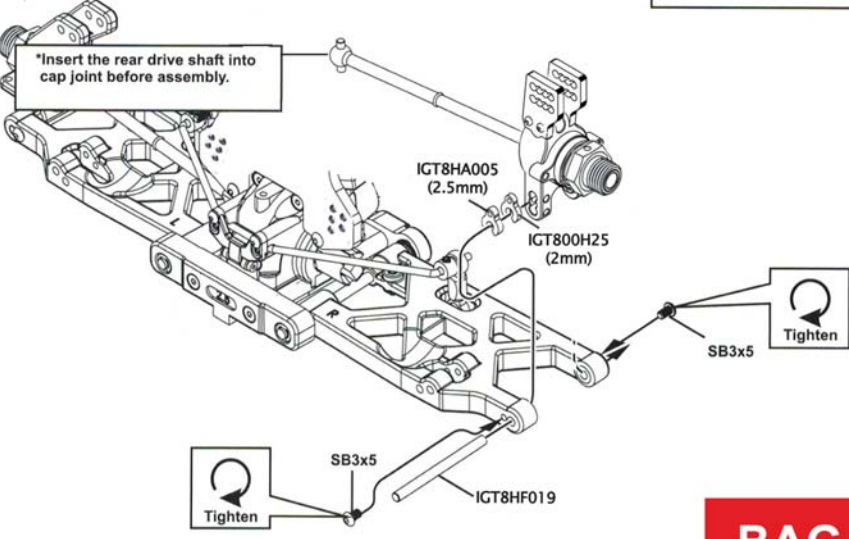
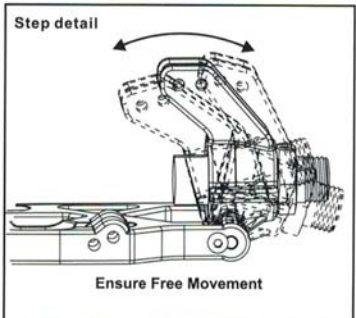

- SB3x5mm Hex Screw .....x4

**BAG 4**

### 33 ASSEMBLY OF THE REAR UPPER ARMS

**BAG 4**

Assemble both left and right sides.

RIGHT SIDE

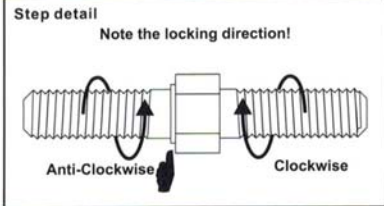
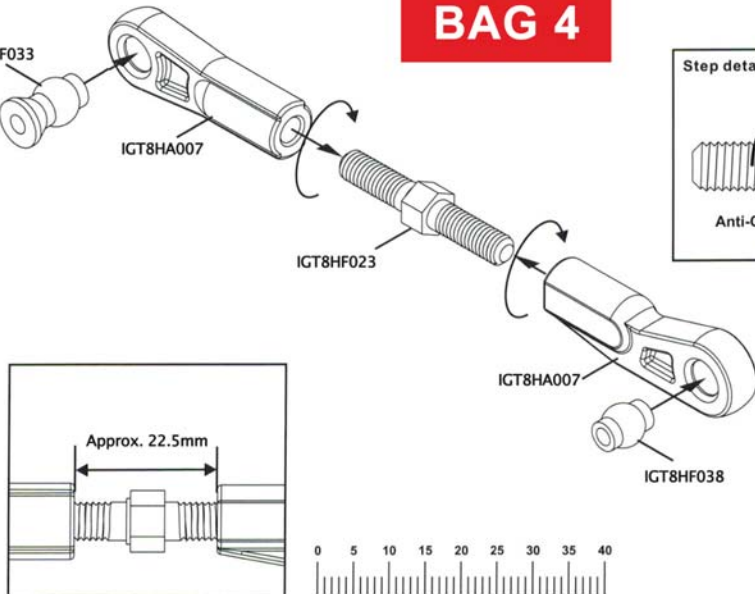
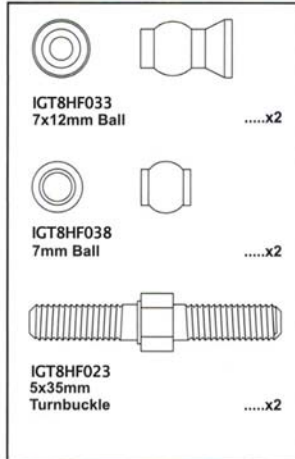

### 34 ASSEMBLY OF THE REAR UPPER ARMS

**BAG 4**

Assemble both right and left sides.

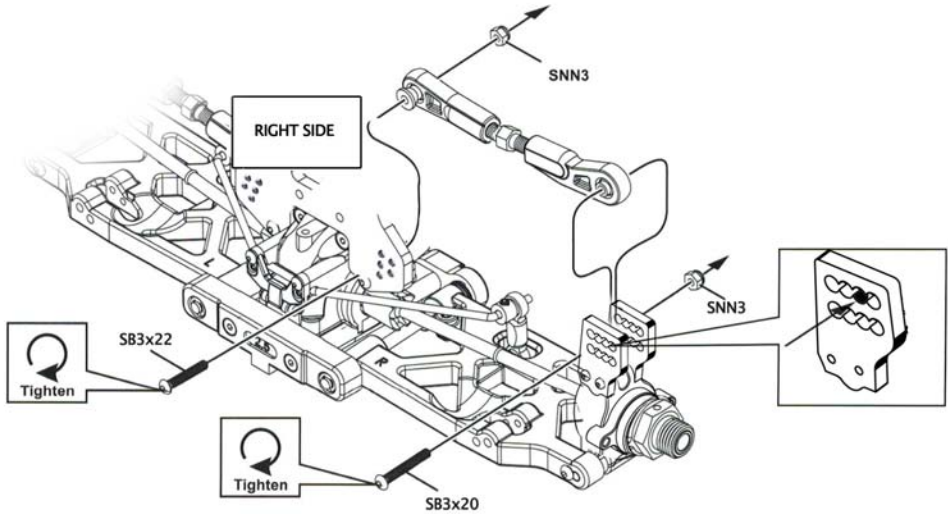
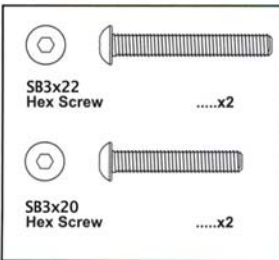

### 35 ASSEMBLY OF THE REAR CENTER BRACE

**BAG 4**

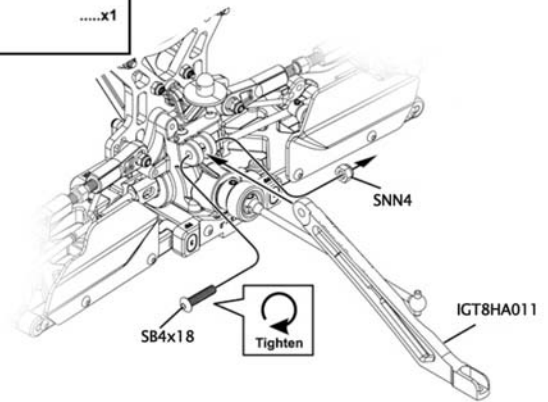
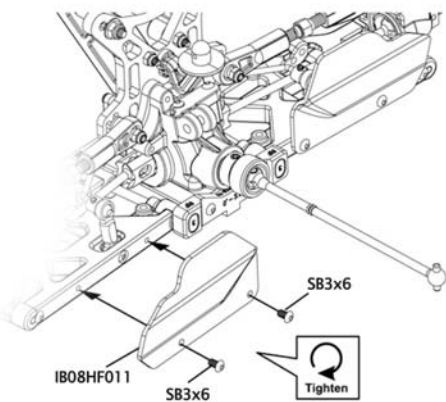
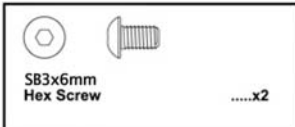



### 37 ASSEMBLY OF THE WING STAY ONTO SHOCK STAY

		.....x2
		.....x2
		.....x2

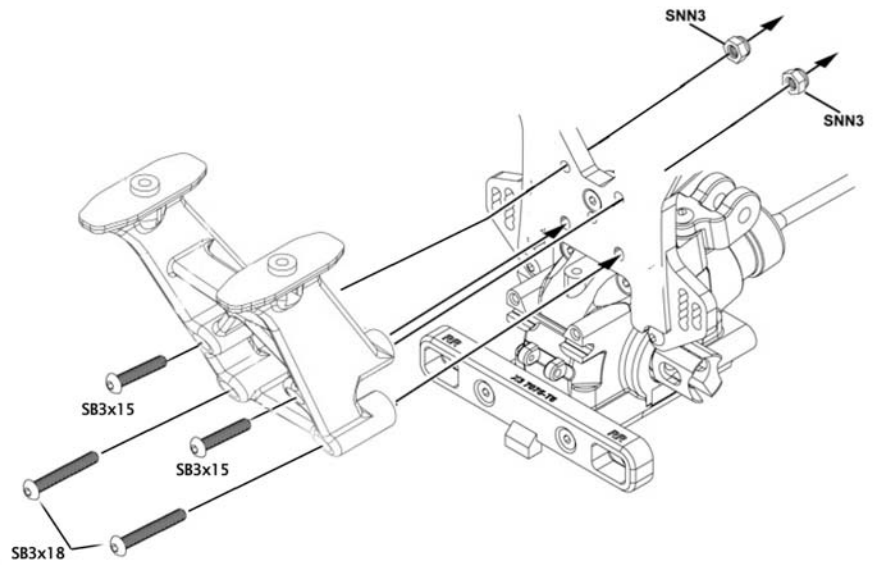

### 38 ASSEMBLY OF THE STONE GUARD

Assemble both right and left sides.

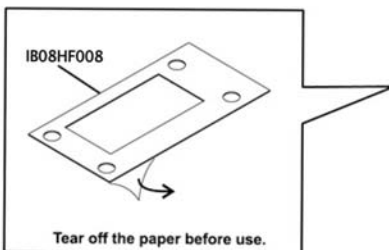



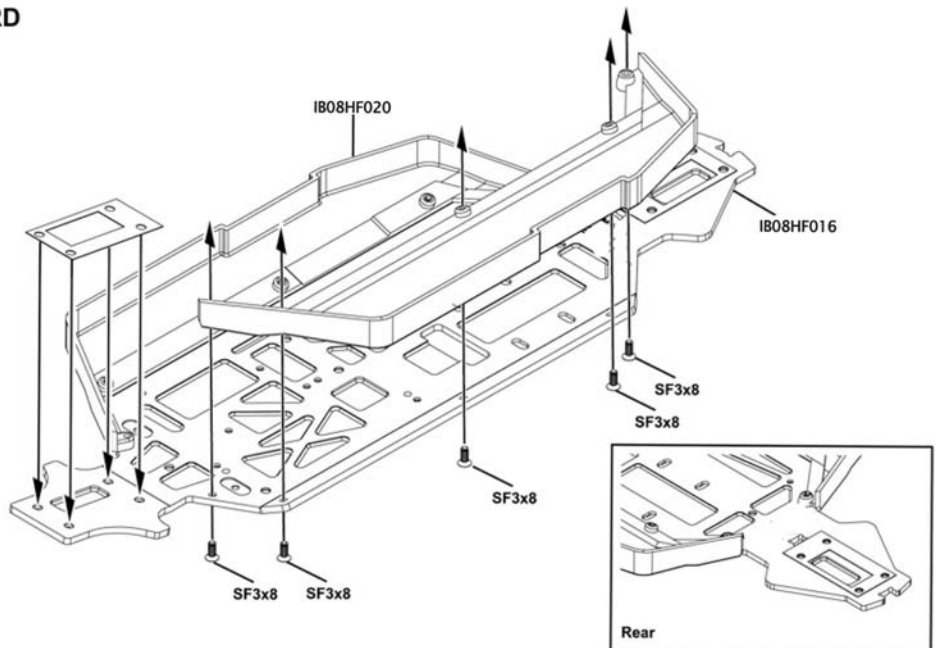

		.....x10
--	--	----------





### 39 ASSEMBLY OF THE FRONT GEAR CASE ONTO CHASSIS

-  SF3x10mm Flat Head Hex Screw .....x2
-  SF4x12mm Flat Head Hex Screw .....x2
-  SF4x16mm Flat Head Hex Screw .....x2
-  SNN3mm Nylon Nut .....x2

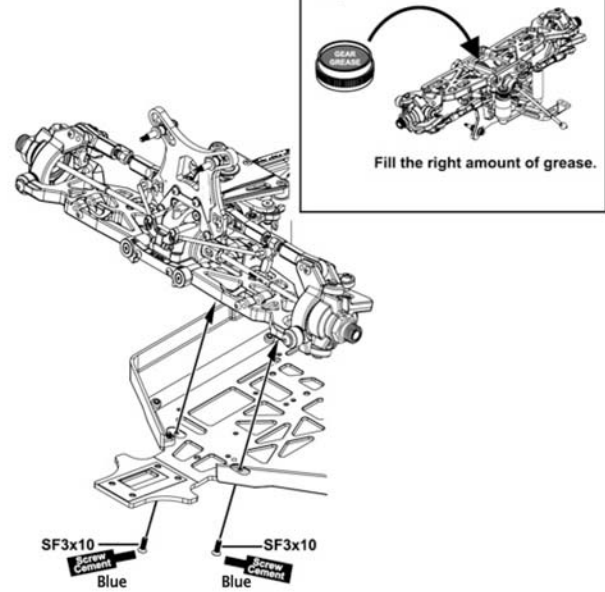
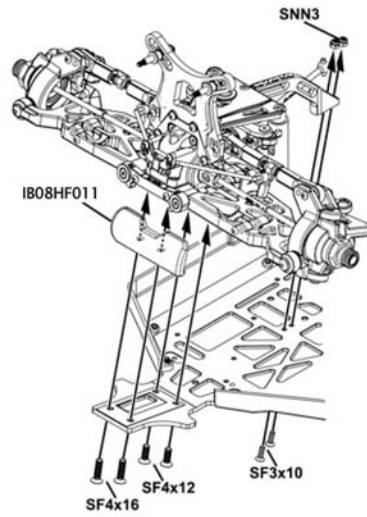



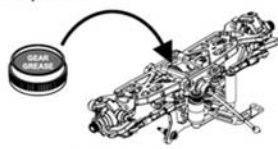

Step detail

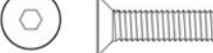

Fill the right amount of grease.

### 40 ASSEMBLY OF THE REAR GEAR CASE ONTO CHASSIS

-  SF3x10mm Flat Head Hex Screw .....x2
-  SF4x12mm Flat Head Hex Screw .....x2
-  SF4x16mm Flat Head Hex Screw .....x2
-  SNN3mm Nylon Nut .....x2





Step detail

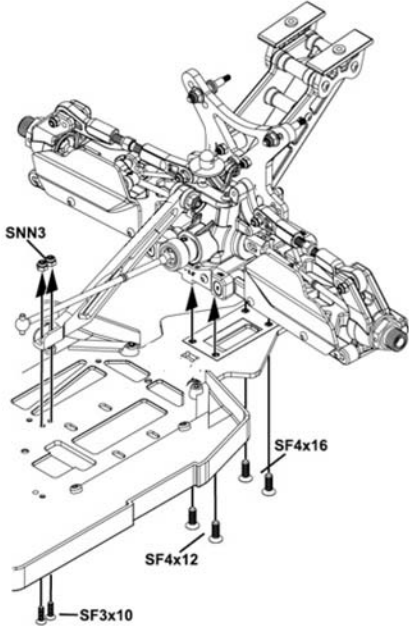

Fill the right amount of grease.



### 41 ASSEMBLY OF THE FRONT CENTER DIFF MOUNT

-  SS3x3mm Set Screw .....x1
-  IGT8HE002 5x8x2.5mm Ball Bearing .....x1
-  SB3x15mm Hex Screw .....x2
-  SB2.5x8mm Hex Screw .....x2

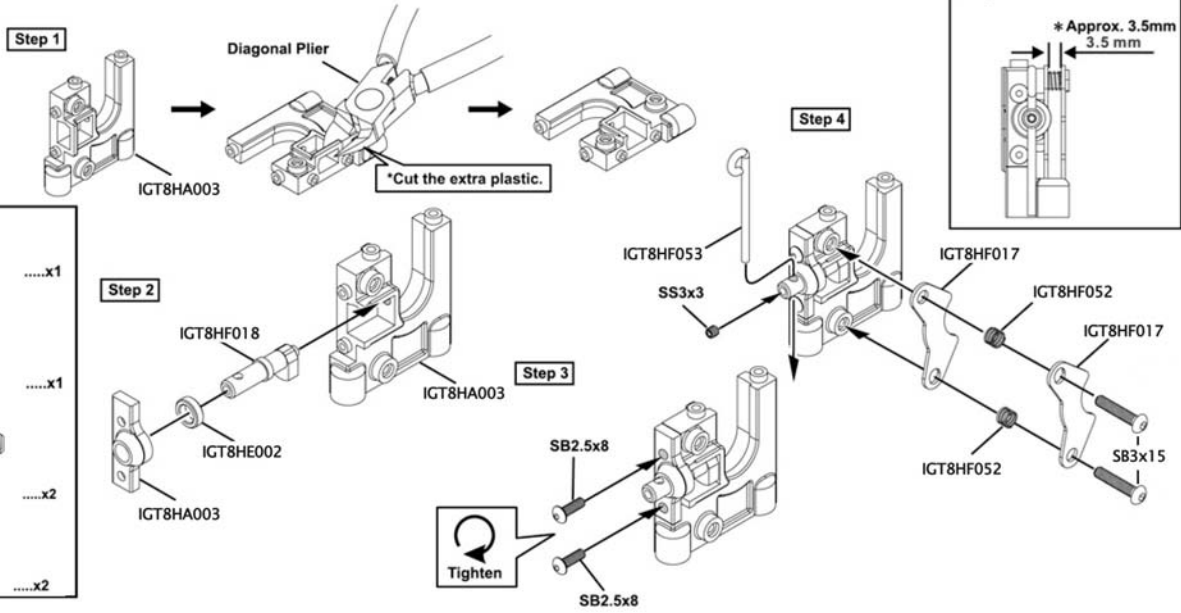

Step detail

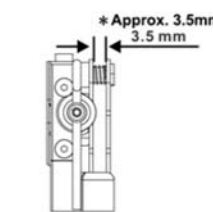

\* Approx. 3.5mm  
3.5 mm

# 41a ASSEMBLY OF THE REAR CENTER DIFF MOUNT

**Step 1**

**Step 2**

**Step 3**

**Step detail**

	SS3x3mm Set Screw	.....x1
	IGT8HE002 5x8x2.5mm Ball Bearing	.....x1
	SB3x15mm Hex Screw	.....x2
	SB2.5x8mm Hex Screw	.....x2

**Step 4**

**BAG 5**

# 41b ASSEMBLY OF THE CENTER DIFF. MOUNT

**SB3x10mm Hex Screw** .....x4



# 42 ASSEMBLY OF THE CENTER DIFF. ONTO CHASSIS

**BAG 5**

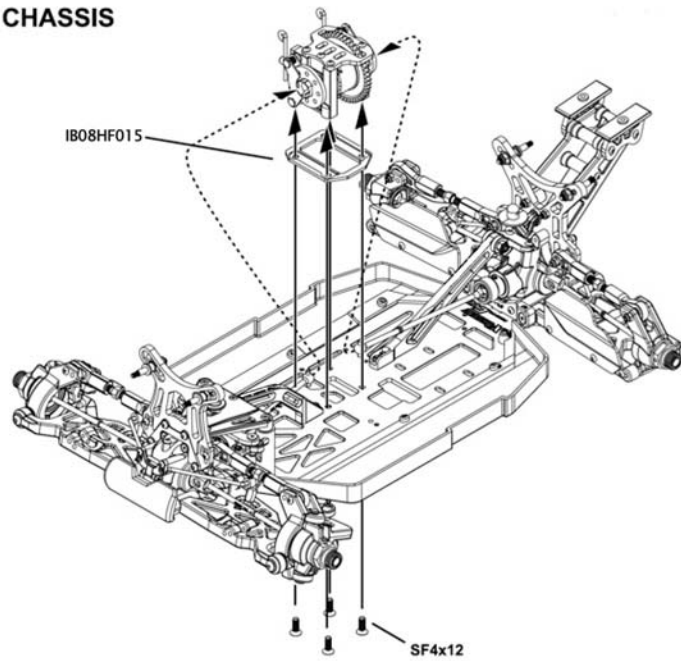
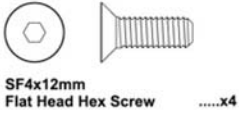

# 43 ASSEMBLY OF THE STEERING ROD

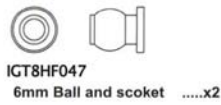
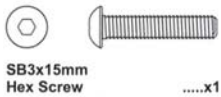
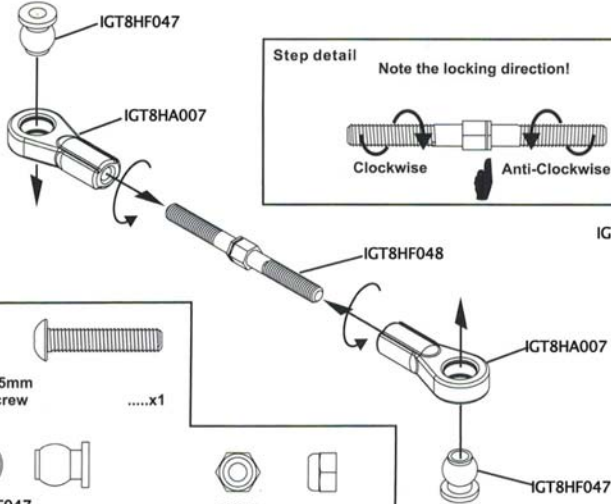

Step 2

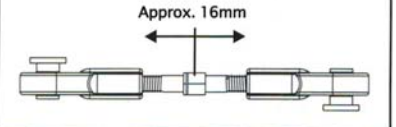
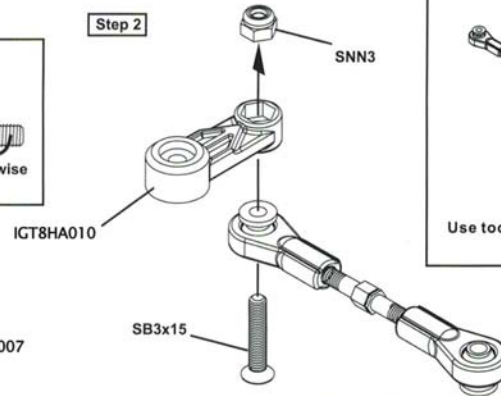

**BAG 10**

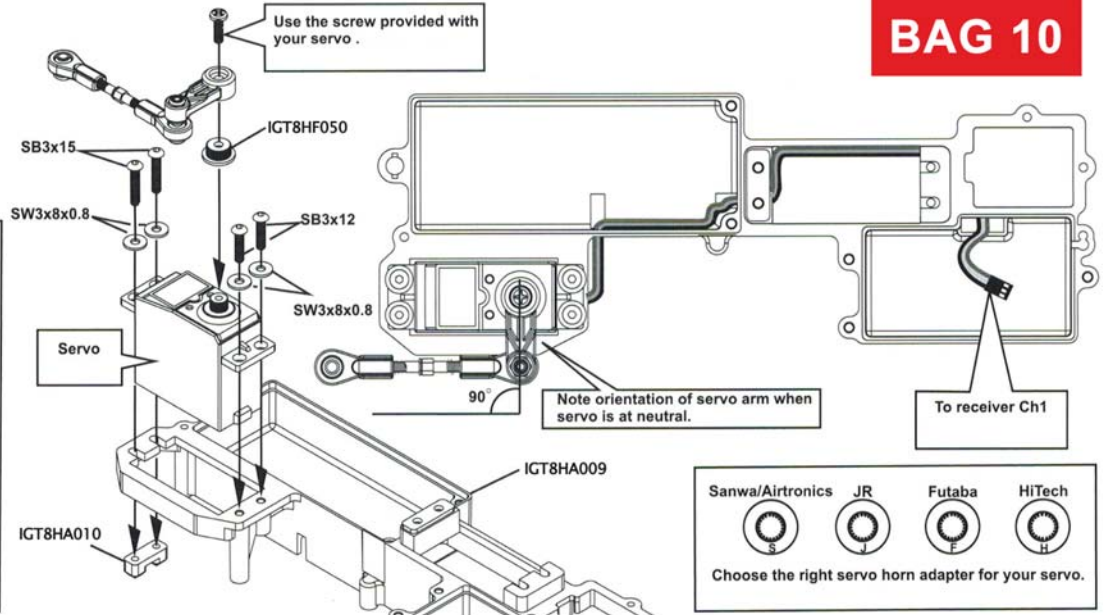
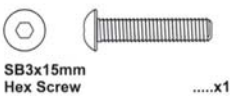
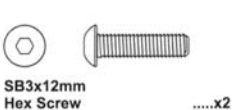
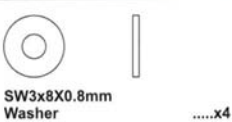

# 44 ASSEMBLY OF THE STEERING SERVO AND RADIO TRAY

**BAG 10**



# 45 ASSEMBLY OF THE THROTTLE SERVO AND RADIO TRAY

**BAG 10**

-  SW3x8X0.8mm Washer .....x4
-  SB3x12mm Hex Screw .....x2
-  SB3x15mm Hex Screw .....x2

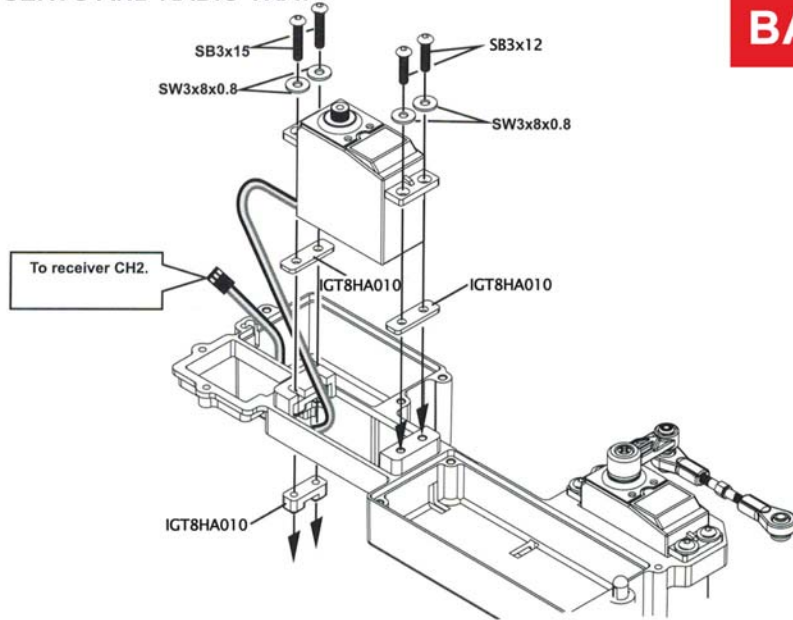

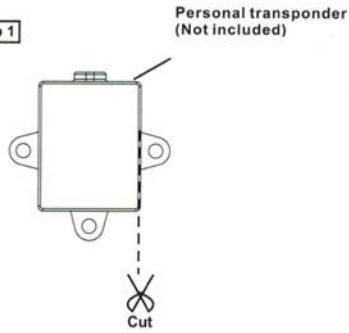

# 47 ASSEMBLY OF THE PERSONAL TRANSPONDER

Step 1

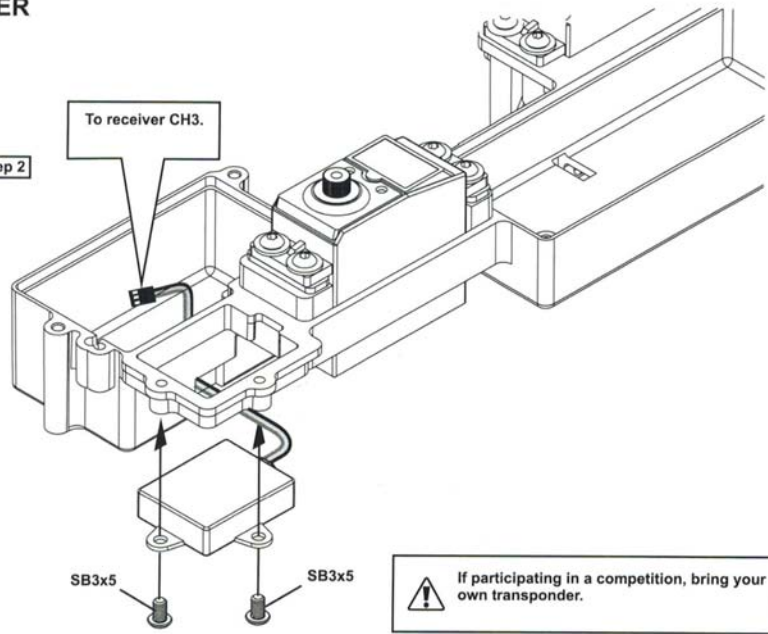

Step 2



-  SB3x5mm Hex Screw .....x2

 If participating in a competition, bring your own transponder.

# 48 ASSEMBLY OF THE RECEIVER INTO RADIO CASE

**BAG 10**

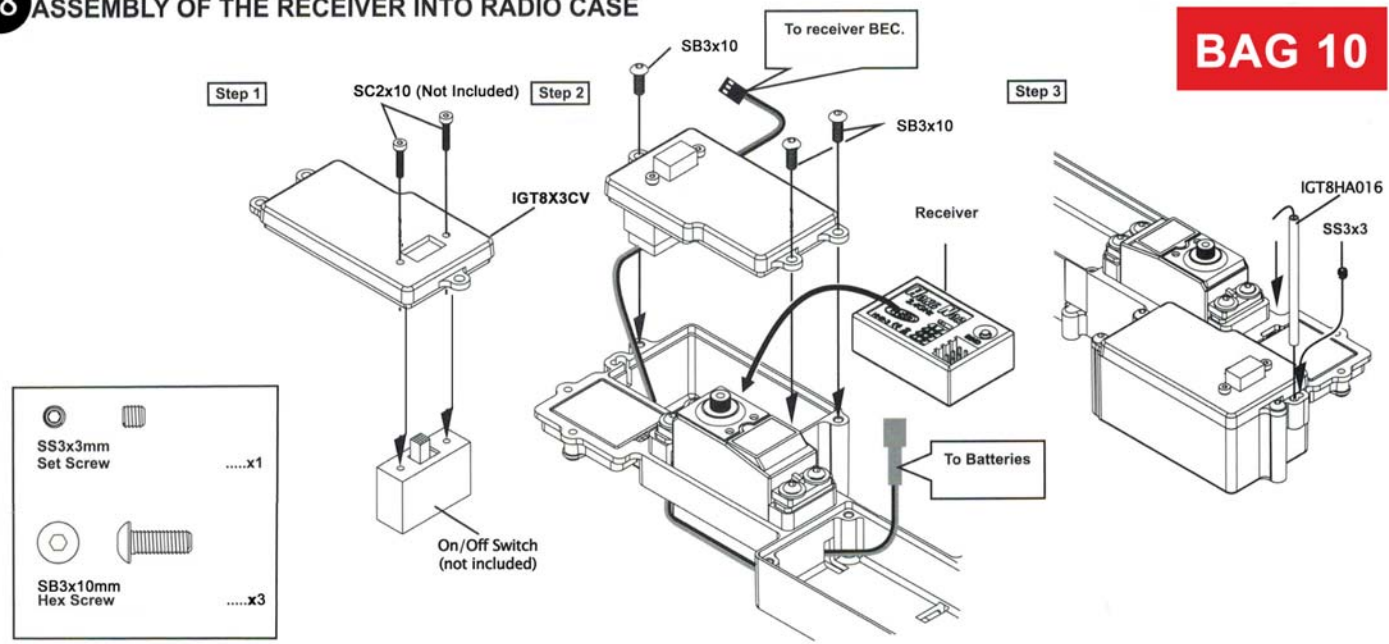

# 49 ASSEMBLY OF THE BATTERY BOX AND RADIO TRAY

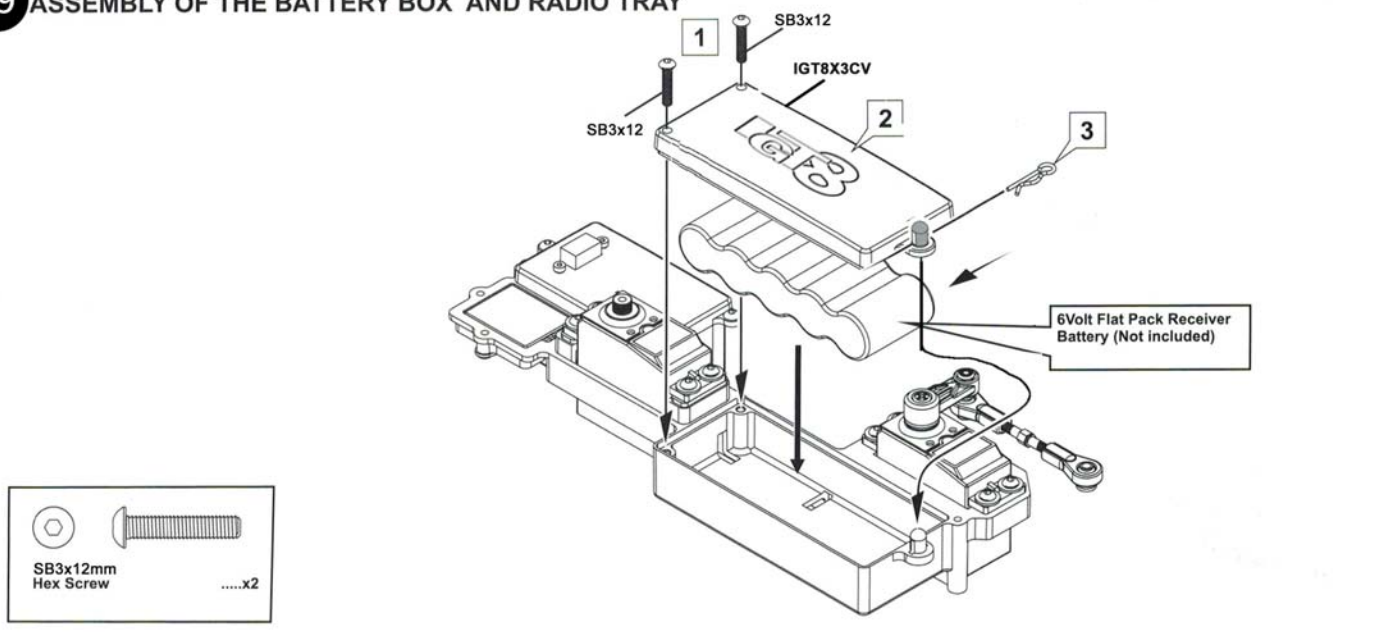

# 50 ASSEMBLY OF THE RADIO TRAY ONTO CHASSIS

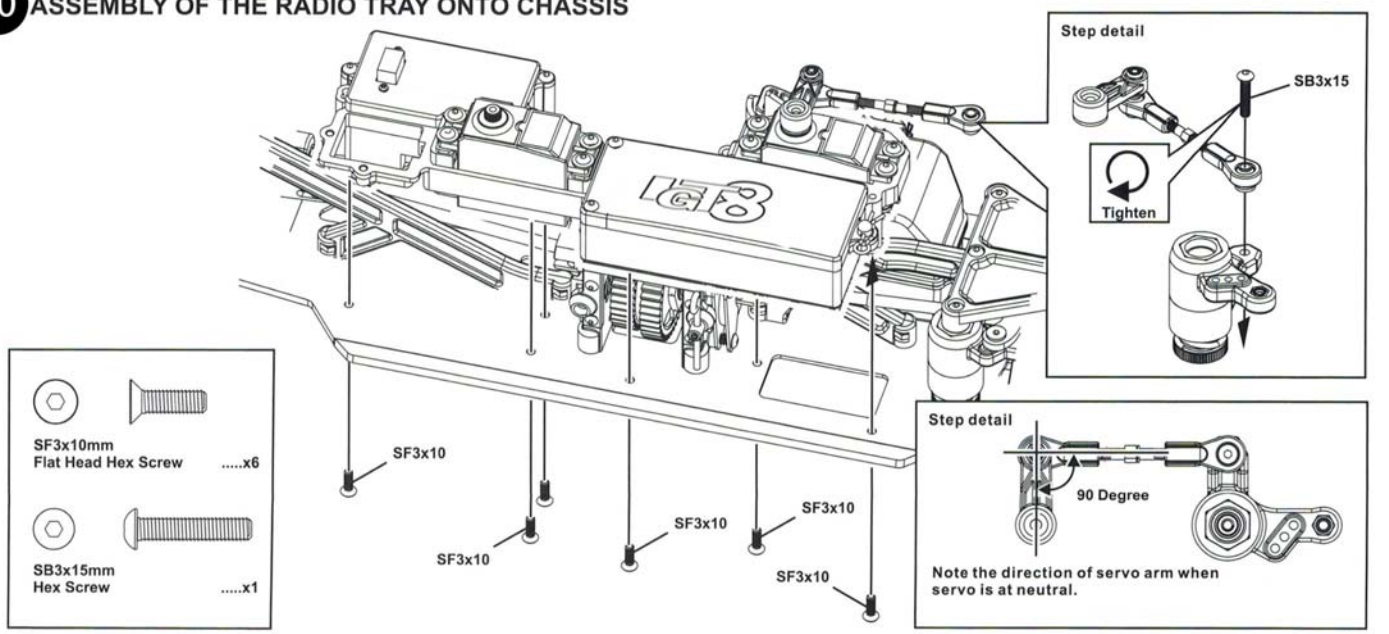



## 52 ASSEMBLY OF THE FUEL TANK

### BAG 7

	.....x1
	.....x2
	.....x1

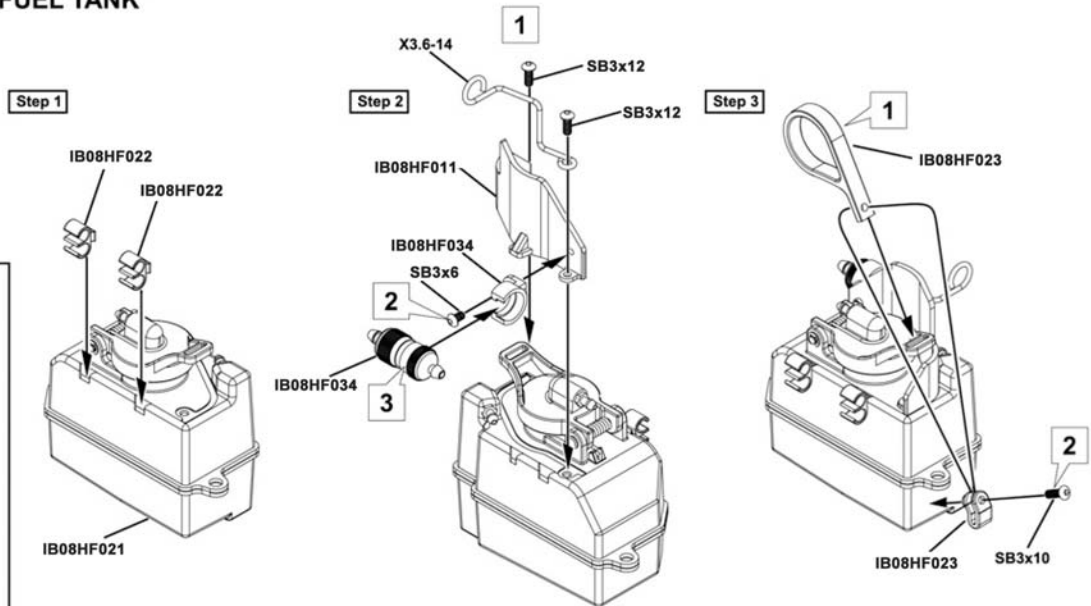



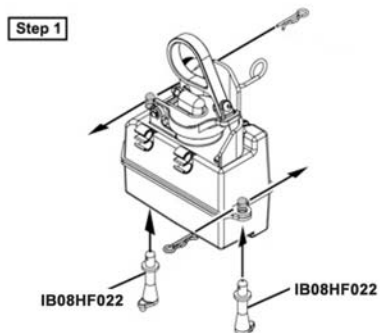

## 53 ASSEMBLY OF THE FUEL TANK ONTO CHASSIS

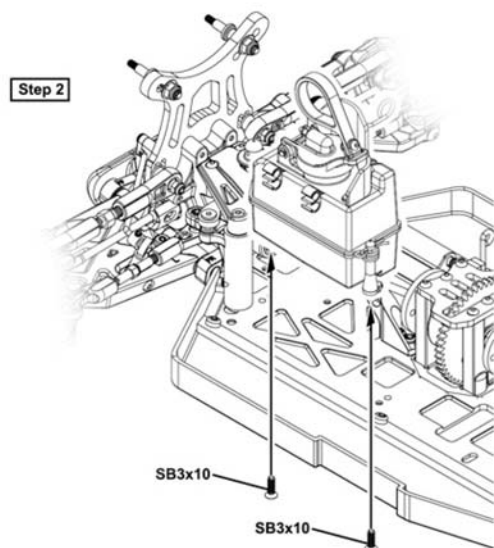

	.....x2
--	---------

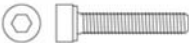

Step 1

-  SC3x8mm Cap Screw .....x1
-  SC3x12mm Cap Screw .....x4
-  SW5x8x0.3mm Washer .....x5
-  SW3x8x0.8mm Washer .....x1
-  IGT8HE003 5x10x4mm Ballbearing .....x2

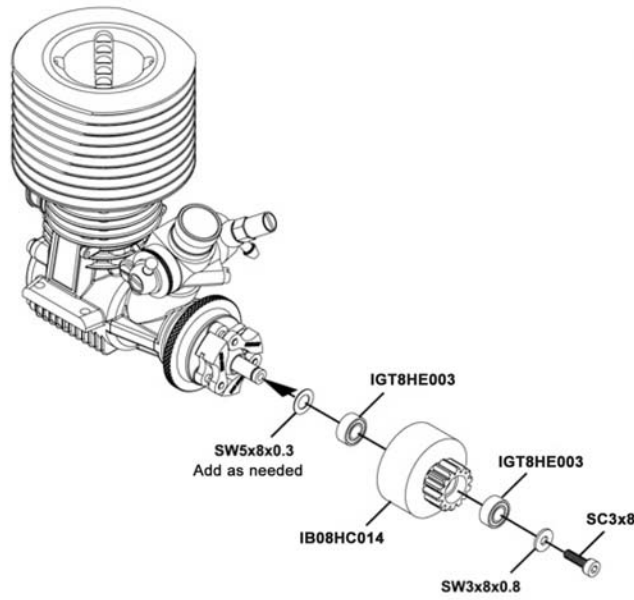

Step 2

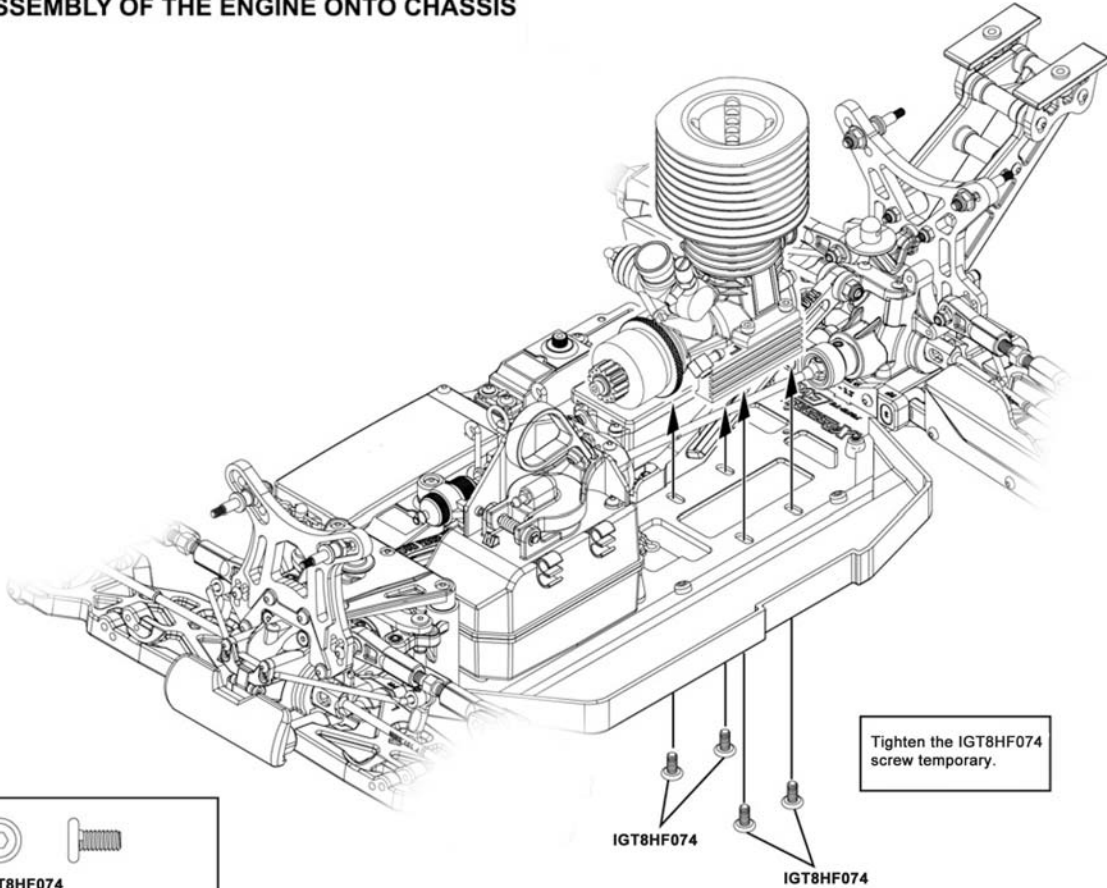
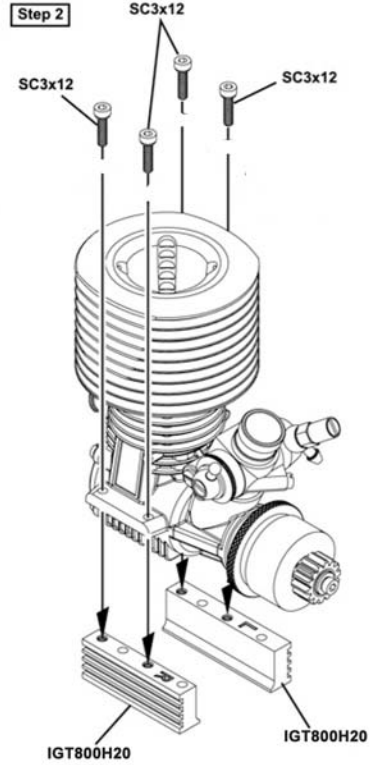

-  IGT8HF074 4x8mm Engine Mount Screw .....x4

**EXTREMELY IMPORTANT**

Step 1

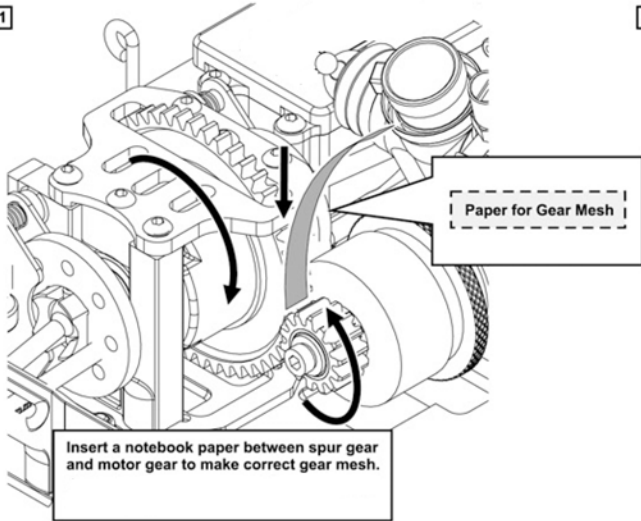

Step 2

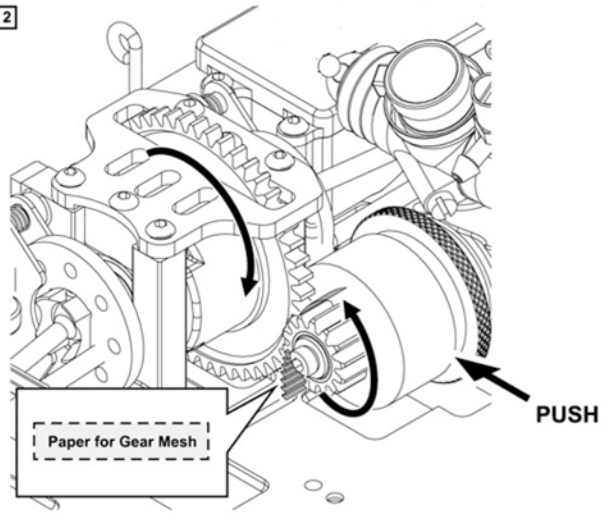

Step 3

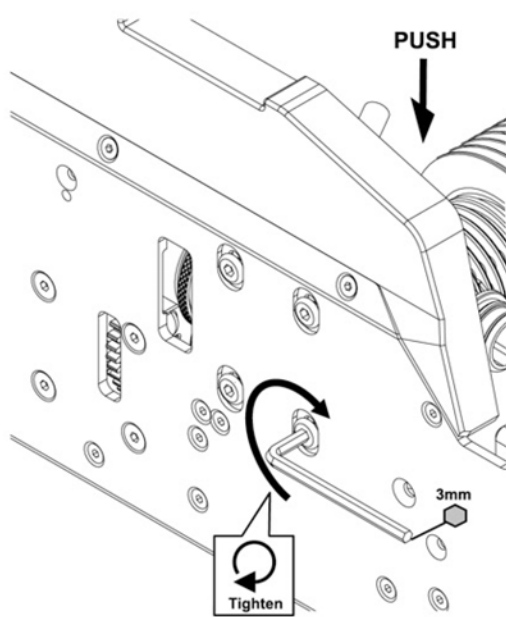

Step 4

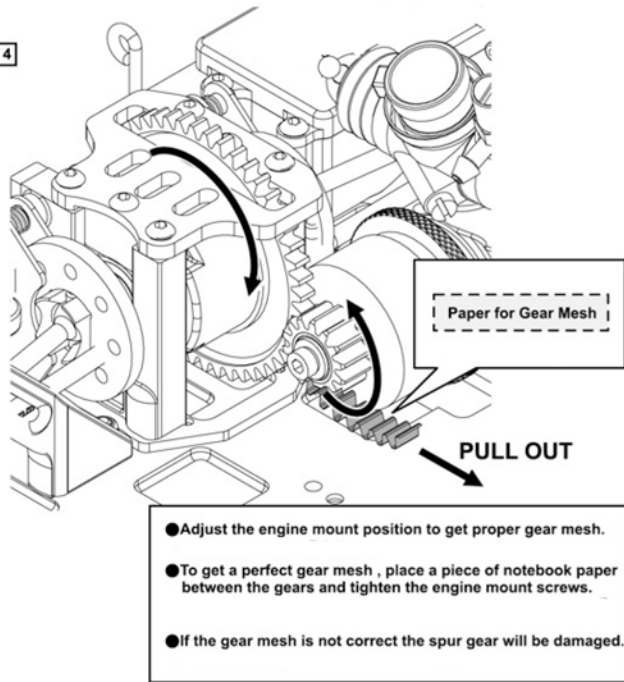



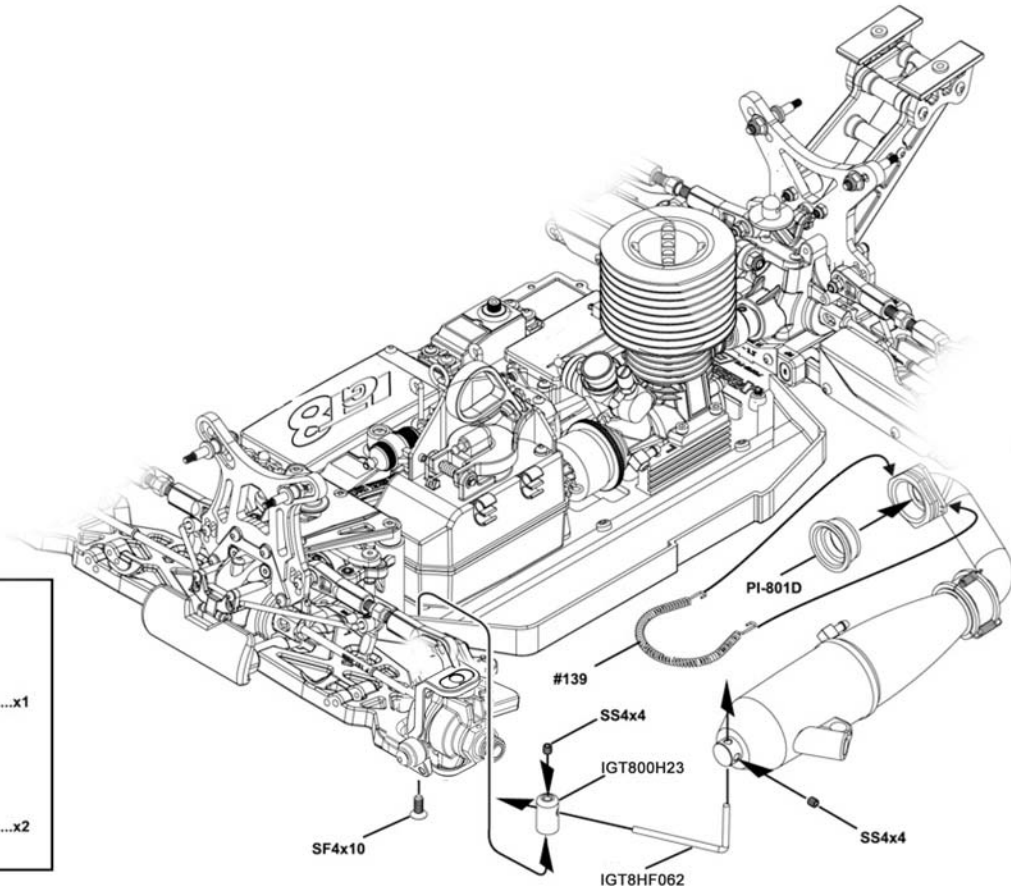

	SF4x10mm Flat Head Screw	.....x1
	SS4x4mm Set Screw	.....x2

**BAG 7**

**BAG 10**

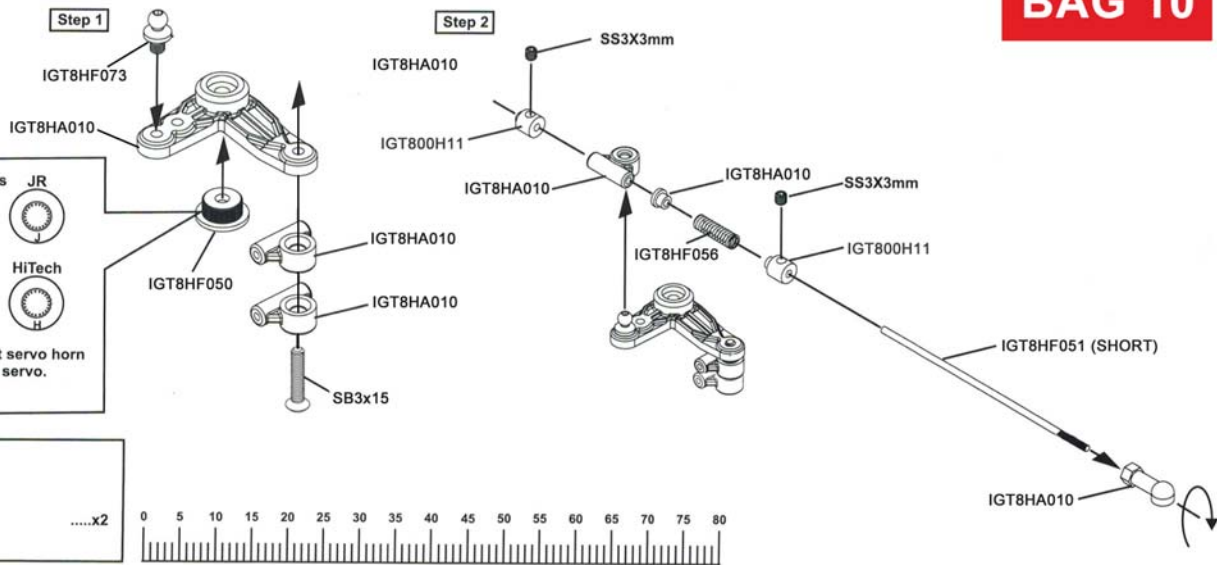

	Sanwa/Airtronics		JR
	Futaba		HiTech

Choose the right servo horn adapter for your servo.

	SS3x3mm Set Screw	.....x2
--	-------------------	---------



## 66 ASSEMBLY OF THE BATTERY BOX AND RADIO TRAY

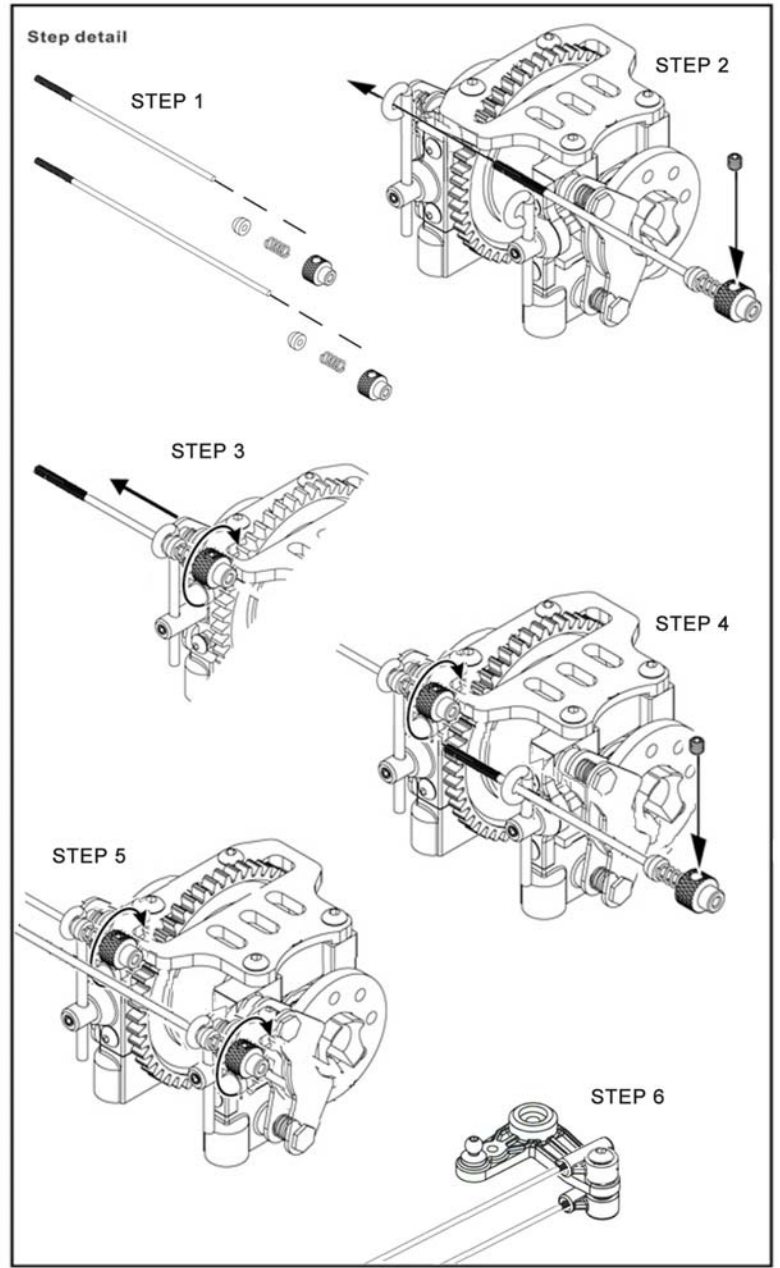
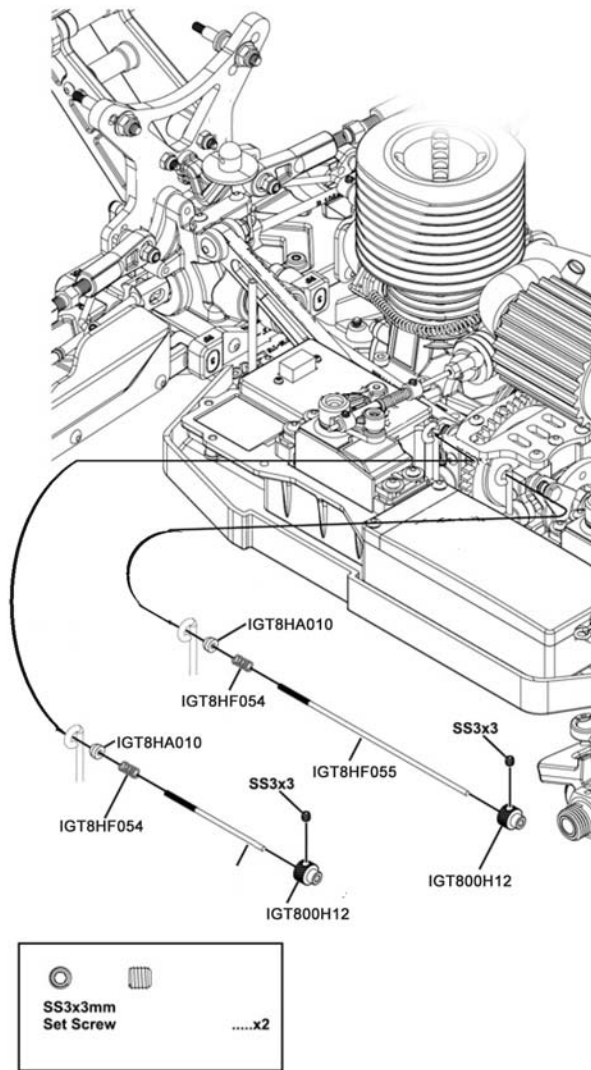

## 67 ADJUSTING THE ENGINE CONTROL LINKAGES

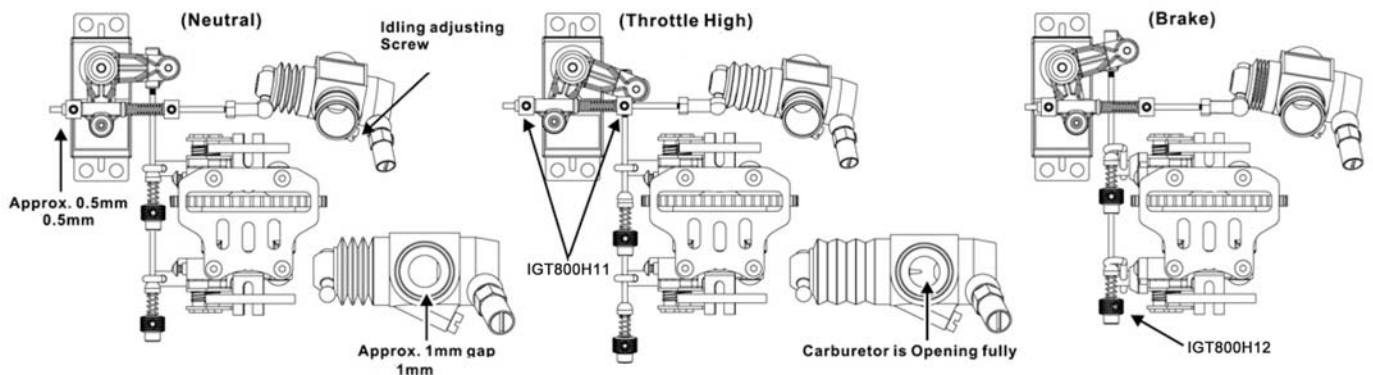

- Turn on the transmitter then the receiver and set the engine control servo trim at the neutral position.
- Adjust the idling adjusting screw on the carburetor to be open approx. 1mm gap.
- Adjust both of the IGT800H12 engine control and brake linkage accordingly.
- Adjust the engine while it is not running.

- Adjust the servo horn mounting position for the carburetor to be full open.
- Change the pivot mounting position on the servo horn in case the carburetor is not opening fully or if it is opening excessively. Or if available on the transmitter, adjust the

- Adjust IGT800H11 so the brakes work smoothly.
- If the brakes apply too much or not enough, adjust IGT800H12 accordingly. Or if available on the transmitter, adjust the high end brake adjustment.

# 68 ASSEMBLY OF THE SHOCK SHAFTS

**BAG 9**

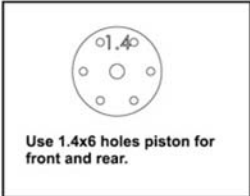

- SNN2.6mm Nylon Nut .....x2
- SW2.6x6x0.5mm Washer .....x4

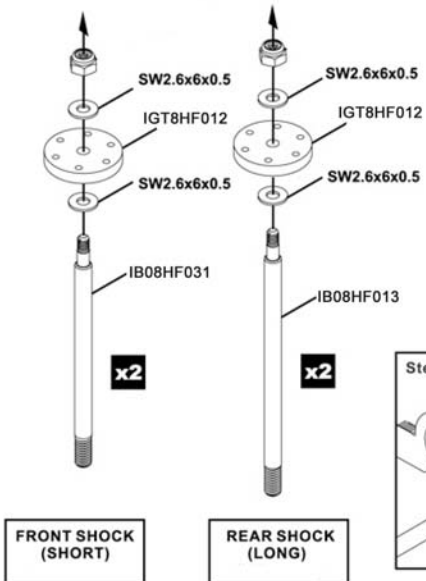

Assemble both left and right sides.

**Step detail**

- Hold the shock rod at its thread with side needle nosed pliers.
- Be careful not to damage the shock rod.

Use tools to tighten as shown.

**Do Not Over Tighten**

**Step detail** (Incorrect) **Step detail** (Incorrect) **Step detail** (Correct)

# 69 ASSEMBLY OF THE SHOCK O-RING

- IGT8HF011 1mm Washer .....x4
- IGT8HF011 2mm Washer .....x4
- IGT8HF011 3.5mm O-Ring .....x8
- IGT8HF064 P10 O-RING .....x4

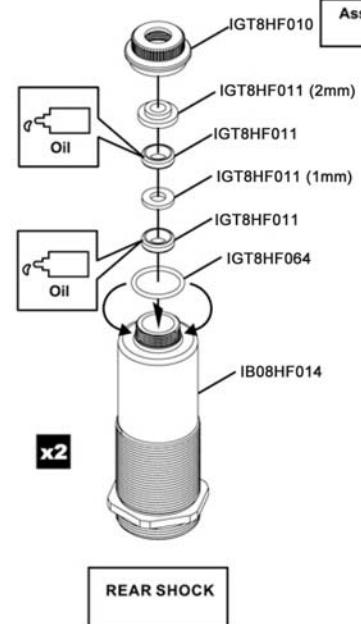
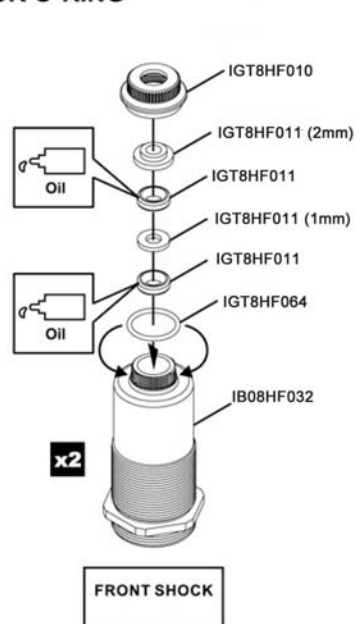

Assemble both left and right sides.

**BAG 9**

# 70 ASSEMBLY OF THE SHOCK SHAFTS INTO SHOCK BODIES

**BAG 9**

Assemble both left and right sides.

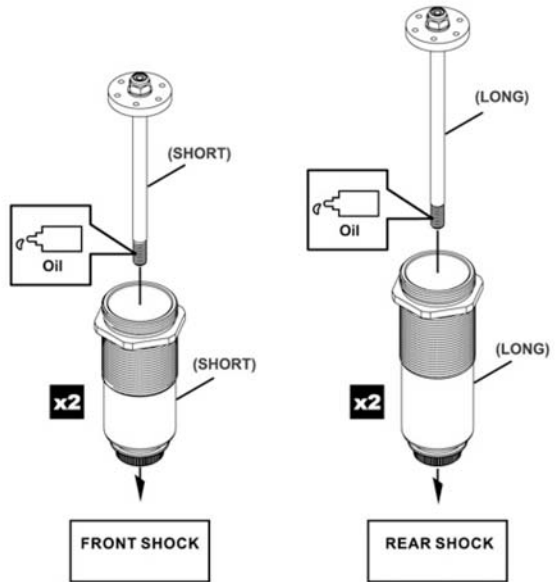

**⚠ EXTREMELY IMPORTANT**

Do not push the shock shaft straight down, O-ring can be damaged.

Slowly twist the shock shaft down to the bottom.

**X**      **O**

# 71 ASSEMBLY OF THE SHOCK ADJUST RING

**BAG 9**

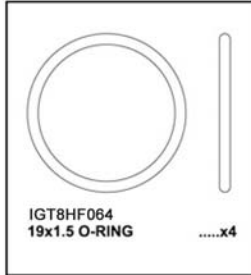

Step 1

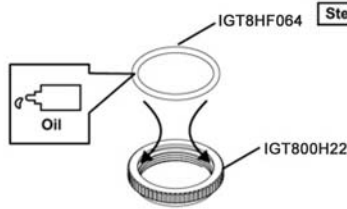

Fit the o-ring into groove before assembly.

Step 2

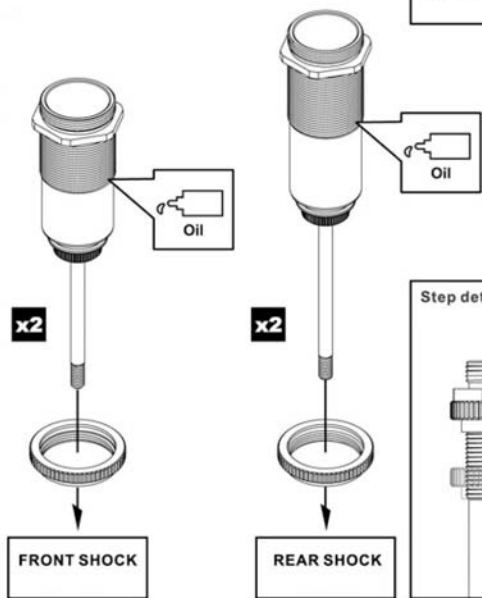

Assemble both left and right sides.

Step detail

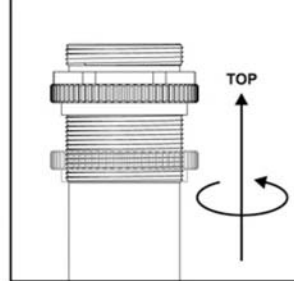

# 72 ASSEMBLY OF THE SHOCK BALL END

**BAG 9**

Assemble both left and right sides.

Step detail

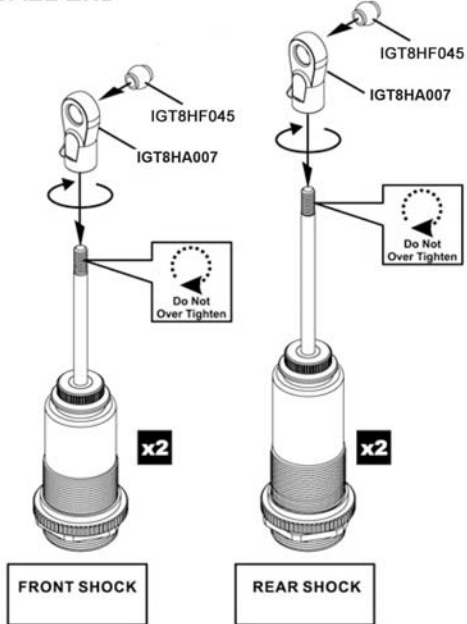
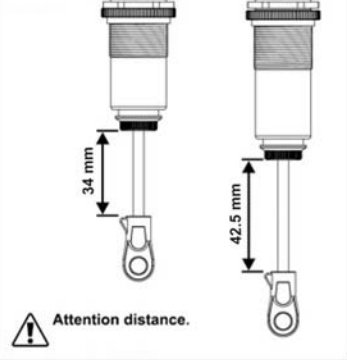

Step detail

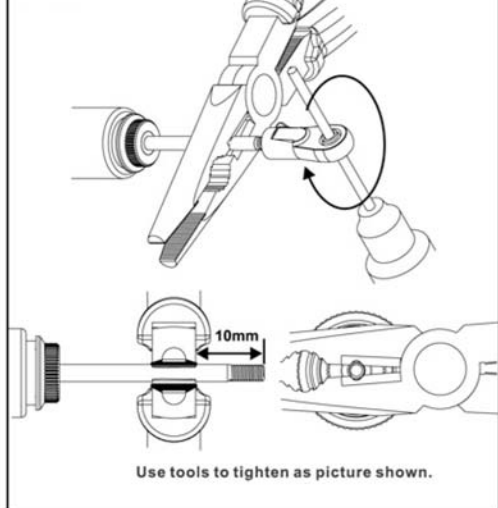

# 73 SETTING THE SHOCK REBOUND TO 100% (HIGH REBOUND)

**BAG 9**

Assemble both left and right sides.

FRONT (SHORT) SHOCKS OIL 350

REAR (LONG) SHOCKS OIL 350

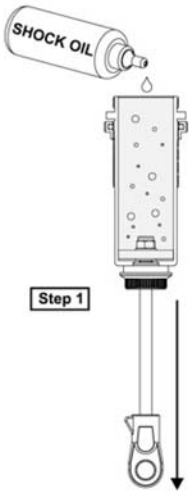

Step 2

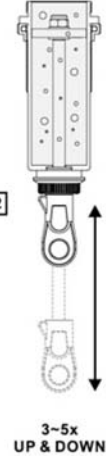

Step 3

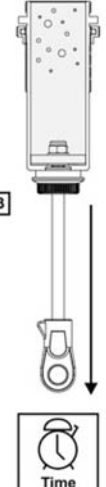

Step 4

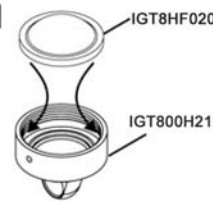

Step detail



TIGHTENED HALF WAY 50%

TIGHTENED 100%

Step 5



Step 6



- Leave the filled shock vertically for several minutes with the shock shaft fully extended.
- The remaining air bubbles will release.

## 74 SETTING THE SHOCK REBOUND TO 50% & 0% (MEDIUM REBOUND & LOW REBOUND)

TIGHTENED HALF WAY 50%

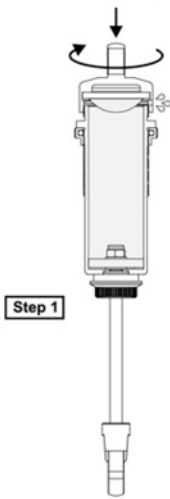

Step 1

TIGHTENED 100%

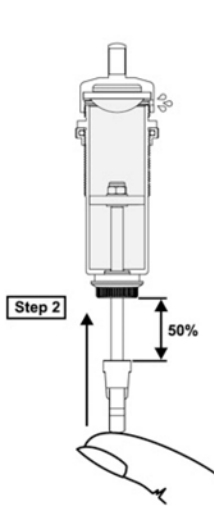

Step 2

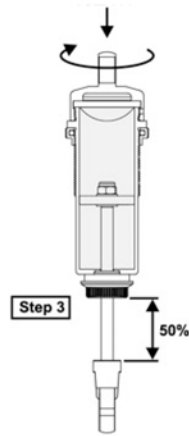

Step 3

TIGHTENED HALF WAY 50%

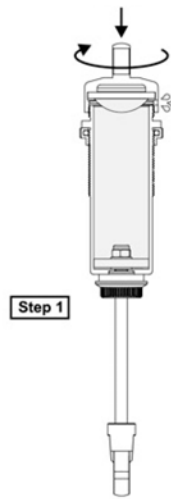

Step 1

TIGHTENED 100%

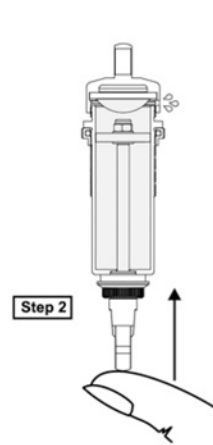

Step 2

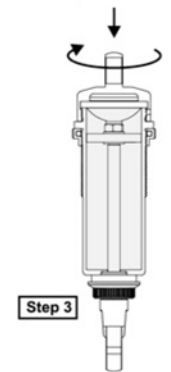

Step 3

## 75 ASSEMBLY OF THE SHOCKS SPRING

Step 1



FRONT SHOCK

Step 2



Step 3

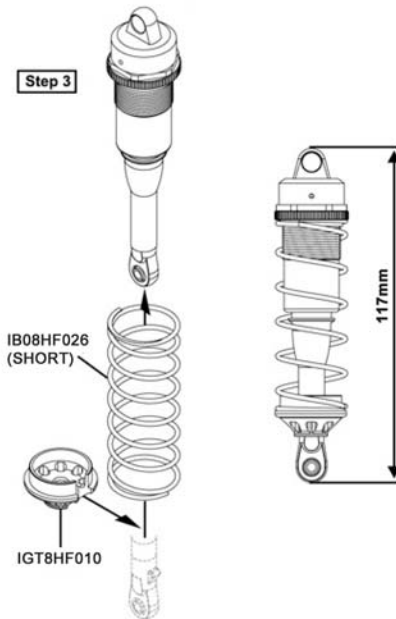

Step 1



REAR SHOCK

Step 2

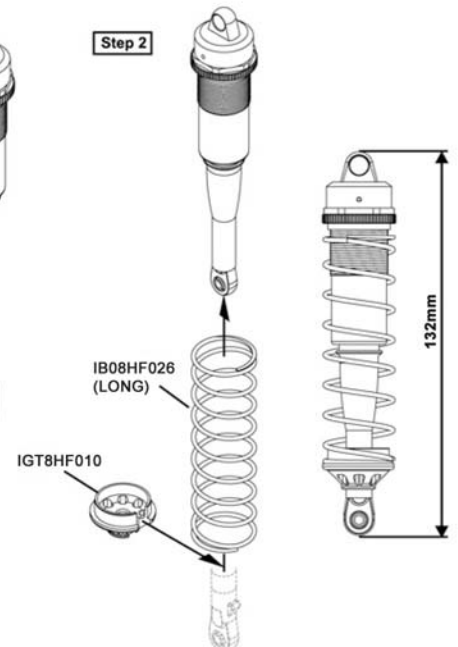

## 76 ASSEMBLY OF THE SHOCKS INTO THE SHOCK STAY

- |  |         |
|--|---------|
|  | .....x2 |
|  | .....x2 |
|  | .....x1 |
|  | .....x1 |

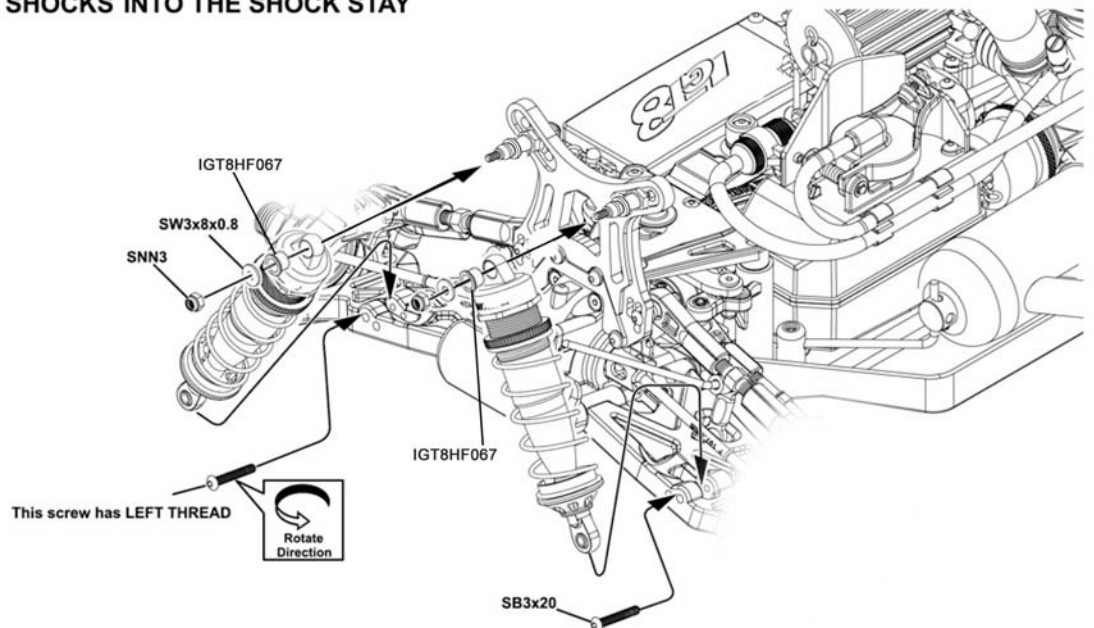

# 77 ASSEMBLY OF THE SHOCKS INTO THE SHOCK STAY

**BAG 9**

	SNN3mm Nylon Nut	.....x2
	SW3x8x0.8 Washer	.....x2
	SB3x20mm Hex Screw	.....x1
	3x20mm Left Thread Hex Screw	.....x1

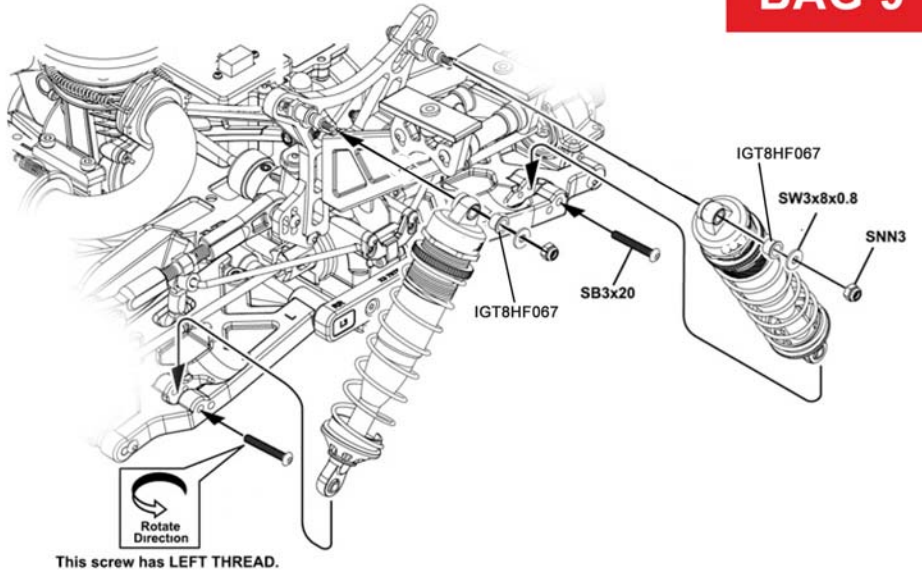

# 78 ASSEMBLY OF THE FUEL TUBE

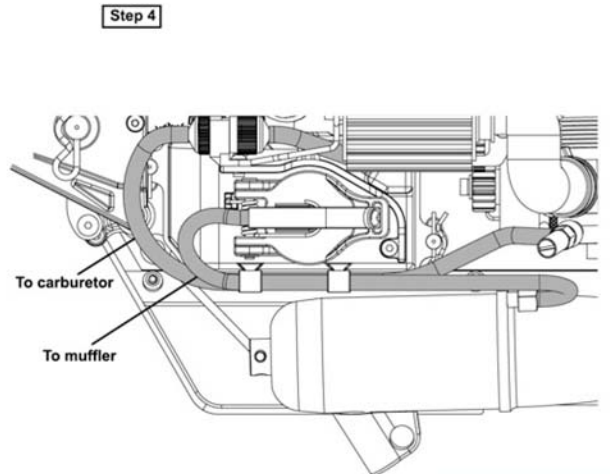
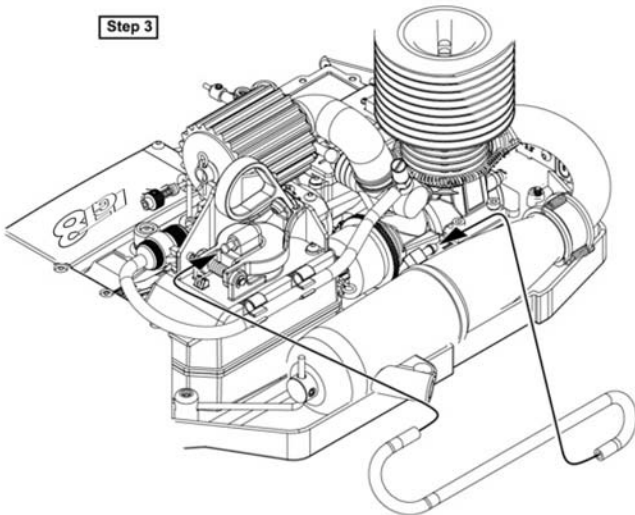
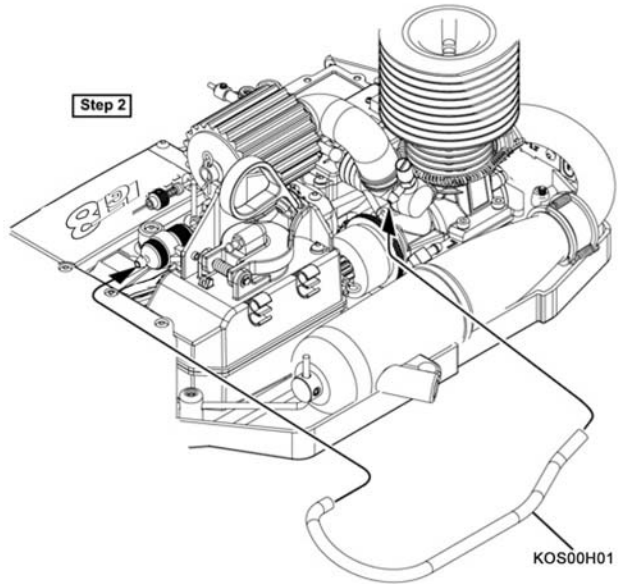
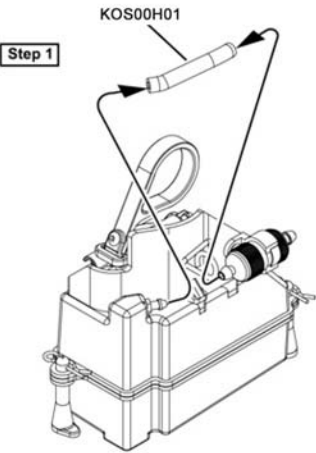

**BAG 7**

79 ASSEMBLY OF THE WING

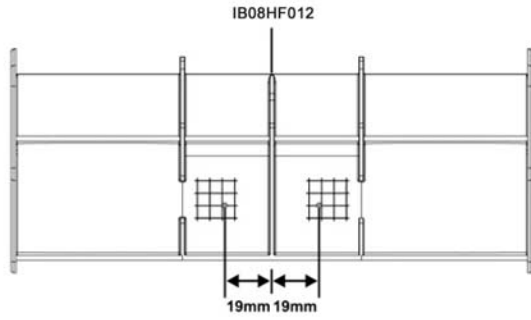

Drill two 7mm holes for mounting.

