



NAME Paolo Morganti RACE Euros 2019 DATE 6/30/19
 TRACK MRC Leipzig CITY/COUNTRY Germany TRACK CONDITION Open

GT 2019 SET-UP SHEET

AIR TEMP 95 F C
 LAPS
 BEST LAP TIME 18.2 in LAP
 TRACK SIZE
 OPEN MEDIUM TIGHT
 TRACK TRACTION
 HIGH MEDIUM LOW

DIFFERENTIAL OIL

FRONT	BEVEL PINION	REAR
<u>13</u>	<u>13</u>	<u>13</u>
<u>43</u>	<u>43</u>	<u>43</u>

OIL wt.
500 FRONT 50 REAR

CLUTCH

BRAND
 COMPOUND ALUM CARBON
 SPRING BRAND
 TENSION mm
 CLUTCH SHOES SHOE

GEARING

SPUR GEAR <u>44</u>	T &	T
PINION GEAR <u>21</u>	T &	T

TIRES

FRONT TYPE PMT
 COMPOUND Q5
 INSERT FOAM Controlled Tires
 REAR TYPE PMT
 COMPOUND Q3
 INSERT FOAM Controlled Tire

ENGINE

TYPE Hobbywing 2600
 PORT
 PLUG
 PIPE

BODY

BRAND Blitz
 TYPE GT3 GBS

NOTES

XRS Plus
 7700 Batteries
 60 grams in the rear

FRONT

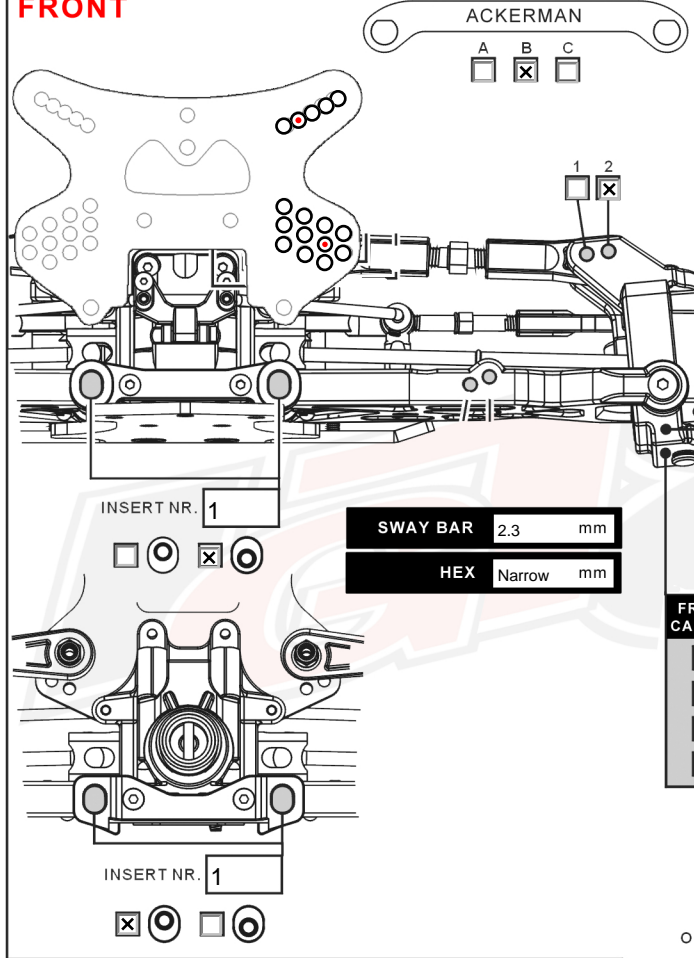

RIDE HEIGHT 8 mm
 DROOP 8 mm
 CAMBER ANGLE 2 °
 TOE ANGLE 1.5 °

PLASTIC ALUM

FRONT SPINDLE CARRIER

PLASTIC ALUM

STEERING KNUCKLEARM

PLASTIC ALUM

FRONT SPINDLE CARRIER CASTER

6°
 10°
 12°
 14°

FRONT SHOCK

OIL wt. 800
 PISTON 1.4 mm
 SPRING 2.3

REAR

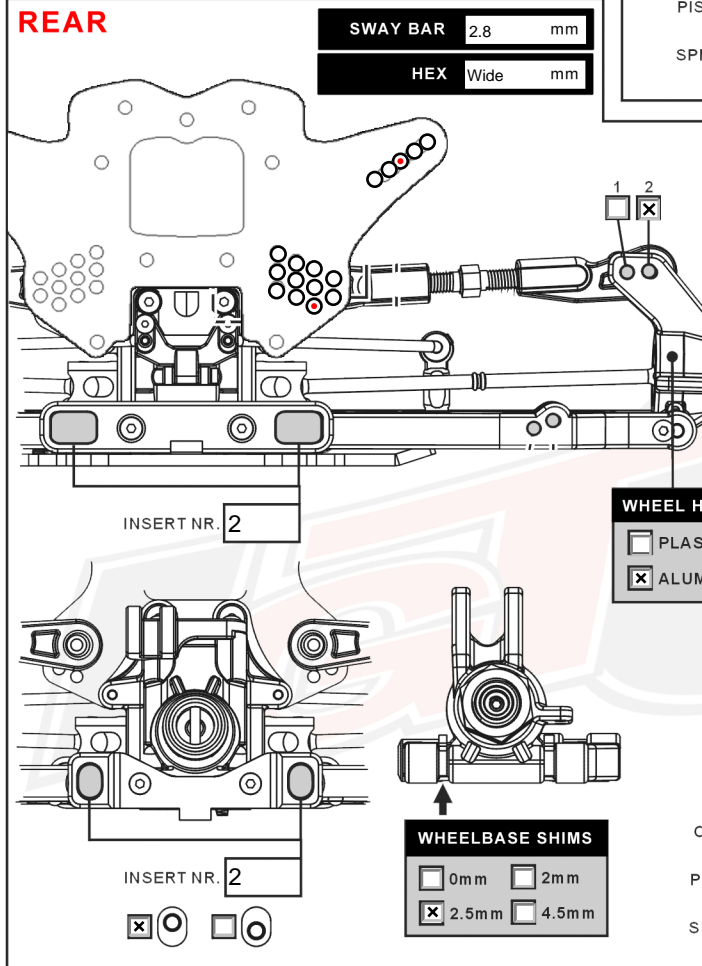

RIDE HEIGHT 9 mm
 DROOP 10 mm
 CAMBER ANGLE 3.5 °

PLASTIC ALUM

WHEEL HUB

PLASTIC ALUM

SUSPENSION ARM

FORWARD BACK

REAR SHOCK

OIL wt. 800
 PISTON 1.4 mm
 SPRING 2.3